

Spezialtiefbau

*Werkzeuge für
echte Helden!*



MADE IN GERMANY

BETEK

Weiterkommen!

Weltweit im Einsatz: BETEK Hartmetall-Werkzeuge



1 - Straßenfräsen



2 - Surface Mining



3 - Stabilisieren



4 - Recycling



5 - Spezialtiefbau



6 - Brechen und Mischen



7 - Horizontales Bohren HDD



8 - Bergbau



9 - Grabenfräsen



10 - Tunnelbau



11 - Baggeranbaufräsen



12 - Forstmulchen



13 - Agrartechnik



14 - Gleisbau



15 - TungStuds

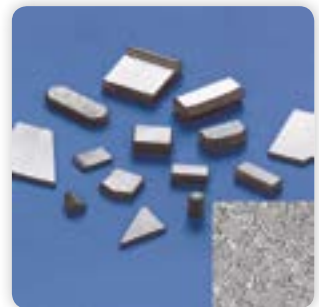

16 - Verschleißschutz

Setzen Sie innovative Werkzeugsysteme von BETEK ein – und Sie werden mit überdurchschnittlichen Tagesleistungen weiterkommen! Hartmetallqualität und Geometrie der BETEK-Werkzeuge sind immer auf die Bearbeitungsaufgabe abgestimmt. Das sichert lange Standzeiten bei weniger Werkzeugwechsel.

Weiterkommen durch verschleißfeste Hartmetallqualität

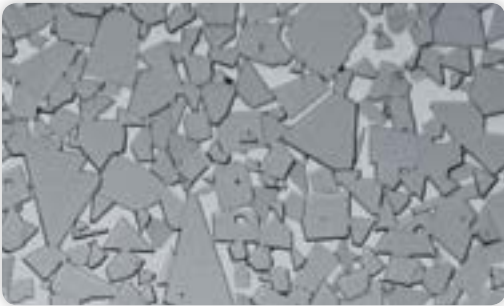

Querschnitt durch Hartmetall der Qualität B20G, wie sie zum Beispiel für den Spezialtiefbau eingesetzt wird

Hartmetall und Stahl – fest verbunden für härteste Belastungen

BETEK-Werkzeuge entstehen aus Hartmetall und Stahl: Hartmetall für die verschleißfeste Meißelspitze, Stahl für Meißelkopf und Werkzeugschaft. Um die beiden Materialien dauerhaft zu verbinden, wurden bei BETEK eigene Verfahren und spezielle Lötanlagen entwickelt. Die Verlotung der beiden Materialien erfolgt mit Überwachung und Dokumentation der Fertigungsparameter. Zusätzlich wird die Lötung auf Scherfestigkeit geprüft.

Dieser Aufwand zahlt sich im harten Einsatz aus. Die Werkzeuge können dabei sehr heiß werden. Da Hartmetall und Stahl unterschiedliche Ausdehnungseigenschaften bei Wärme haben, treten extreme Zugspannungen auf. Und hier kommt das Speziallot von BETEK ins Spiel, das Hartmetall mit Stahl verbindet. Es nimmt die Zugspannungen auf und hält diesen Stand – damit Helden der Baustelle keine Zeit durch Werkzeugbruch verlieren.



Überwachte Fertigung auf der vollautomatischen Lötanlage



Das Löten für eine dauerhafte Verbindung von Hartmetall und Stahl

So entstehen unsere High-Tech-Werkzeuge

- Wirtschaftliche Kundenlösungen aufgrund flexibler Strukturen
- Individuelles, schnelles Eingehen auf Kundenanforderungen

Kundenservice

- Zeitnahe Realisation von Mustern und Prototypen
- Konkurrenzfähige Preise durch enge Zusammenarbeit mit allen Produktionsbereichen

Entwicklung & Konstruktion

- Verwendung von Rohstoffen hoher Reinheit für hohe Festigkeit
- Konstant hohe, porenfreie Hartmetallqualität durch eine exakte Prozessführung dank jahrelanger Erfahrung und Know-how

Hartmetallfertigung

Eigens und bis zur Perfektion entwickelte Produktionsanlagen und Fertigungsprozesse von den Experten in der Verbindung von Hartmetall und Stahl

Produktionsbereich Löten

Wettbewerbsfähigkeit auf dem Weltmarkt durch einen hohen Automatisierungsgrad und flexible Fertigungsanlagen

Automatisierung

Permanente Qualitätsprüfungen der gesamten Fertigungskette bis zur Baustelle nach DIN ISO 9001:2000 und DIN EN ISO 14001

Qualitätssicherung

Anwender-Schulungen im Hause BETEK oder direkt auf der Baustelle für langfristigen wirtschaftlichen Erfolg und Kundenzufriedenheit

Training

kurzfristige Reaktionsmöglichkeiten durch

- Einsatz modernster EDV und optimale Logistik-Vernetzung
- Lagerhaltung von Standardprodukten

Logistik



Werkzeugprogramm

Seite

Anschweißstollen	6 – 8
Wechselstollen	9 – 12
Anschweißzähne	13 – 14
Dragon Tooth	15
Flachzähne	16 – 19
Piloten	20
Rundschaftmeißel Schaftsystem Ø 11,3 mm/0,44", 13 mm/0,52"	21
Rundschaftmeißel Schaftsystem Ø 14 mm/0,55", 18,7 mm/0,74"	22
Rundschaftmeißel Schaftsystem Ø 19,4 mm/0,76"	23
Rundschaftmeißel Schaftsystem Ø 25 mm/1"	24 – 25
Rundschaftmeißel Schaftsystem Ø 38/30 mm - 1,5/1,18"	26 – 27
Bohrrohrverschraubungen	28 – 29
Zähne für Schlitzwandfräsen	30
Verschleißschutz	31

Unter den Werkzeugabbildungen auf den nächsten Seiten finden Sie folgende Informationen:



Bemaßung: mm / Zoll

Schweißanleitung:

www.betek.de/de/produktprogramm/spezialtiefbau-anwenderinfo.html



SERVICE:

Deutschland: info@betek.de

Tel.: +49 (0) 74 22 / 5 65-591

Anschweißstollen

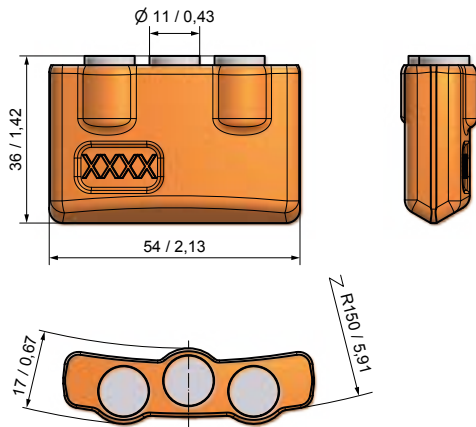

BA12
BA55-17/11/R

50

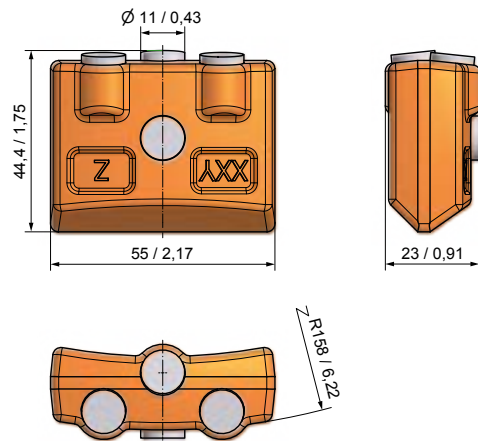

BA13
BA55-22

50

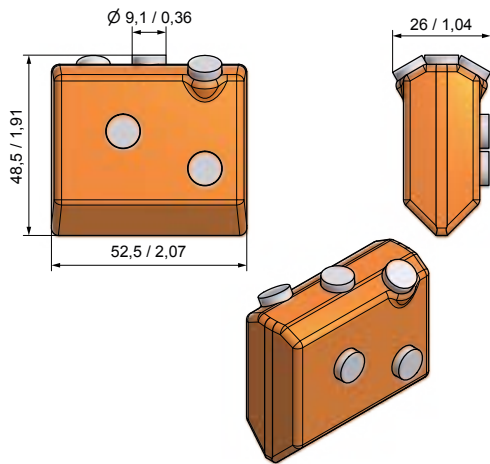

BA12
BA50-26.5

50

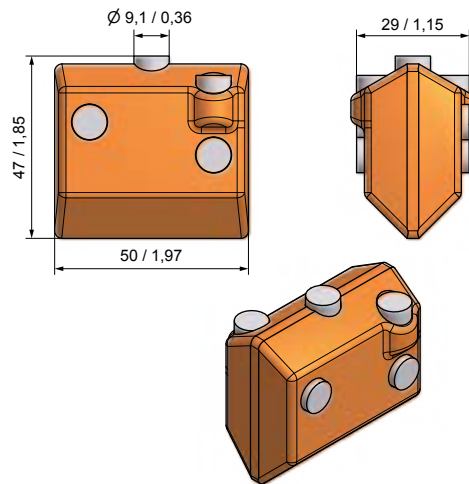

BA13
BA50-29

30

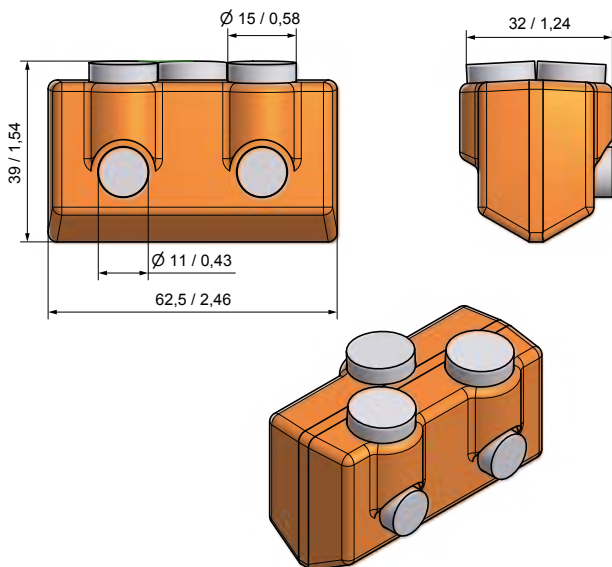

BA32
BA60-32/2

25

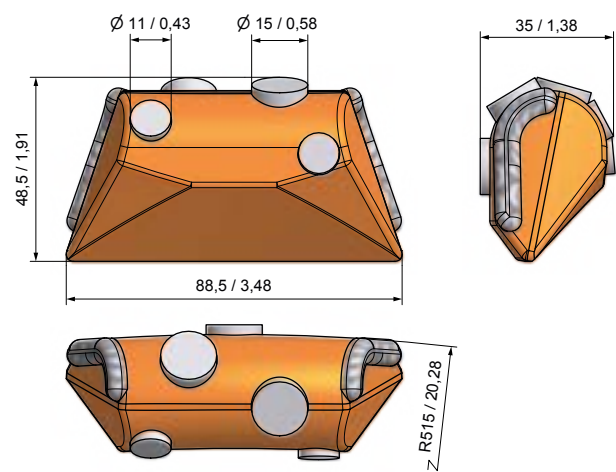

BA01
BA90-35

25

Anschweißstollen

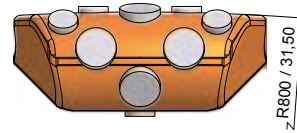
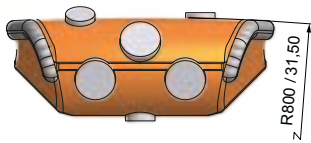
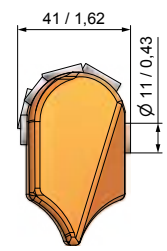
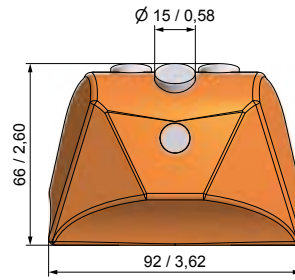
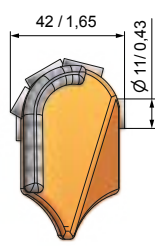
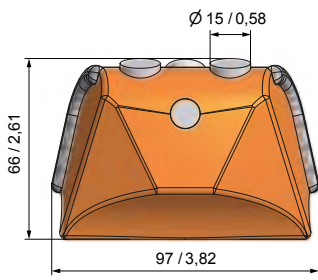

BA24
BA90-42



BA62
BA92-41

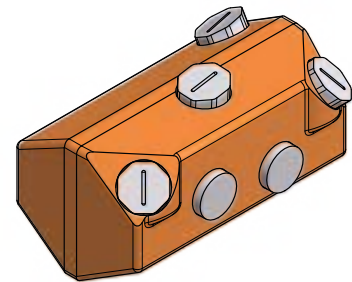
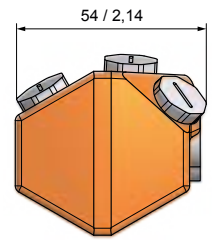
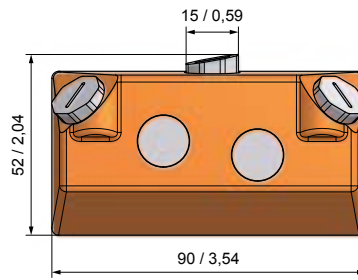
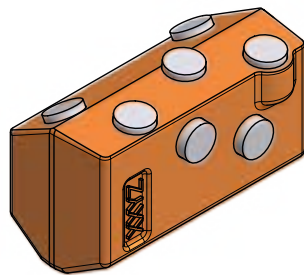
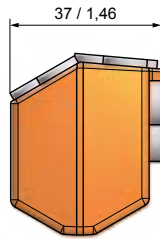
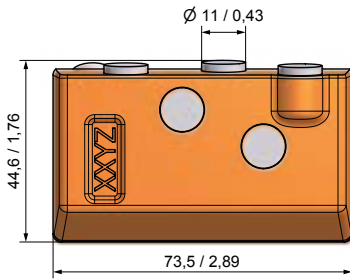

BA04
BA70-38



BA19
BA90-54



Anschweißstollen

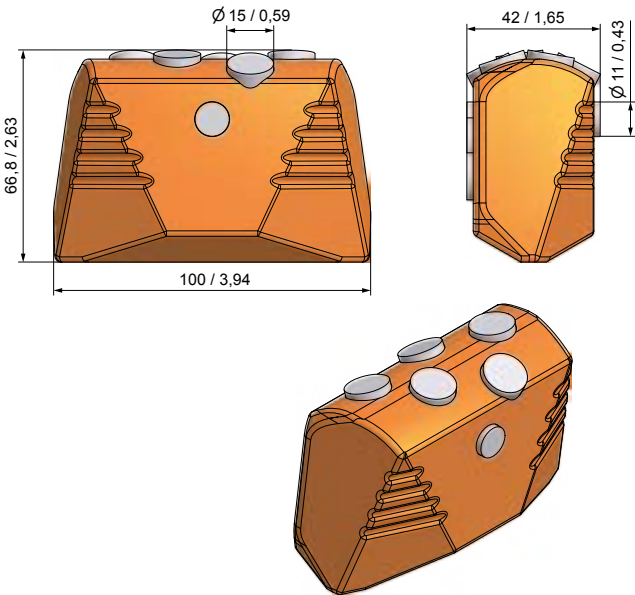

BA55
BA100-42

10

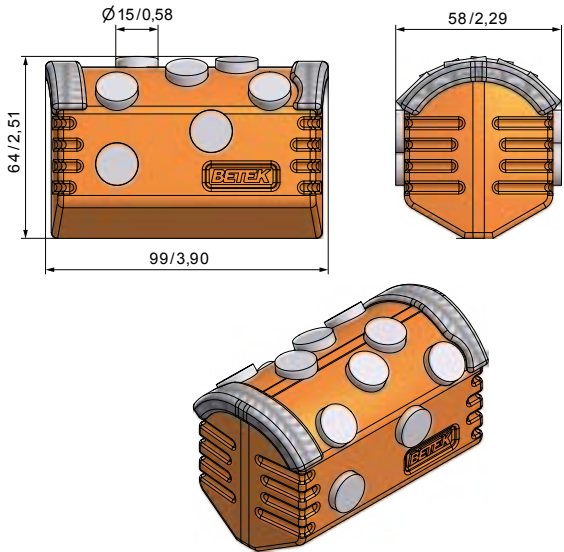

BA28
BA90-58/3

8

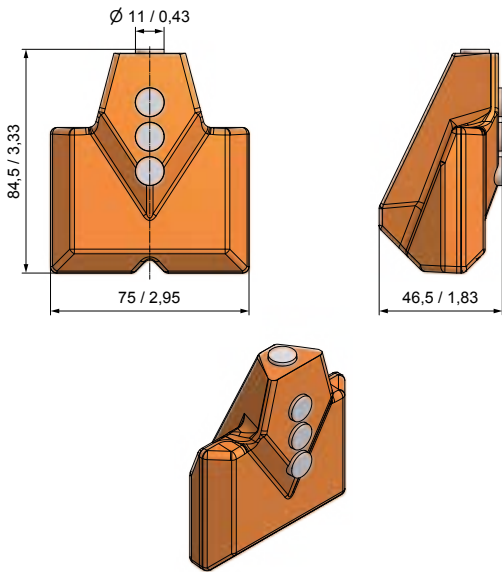

BFZ26
BFZ83x75x45 / 1

15

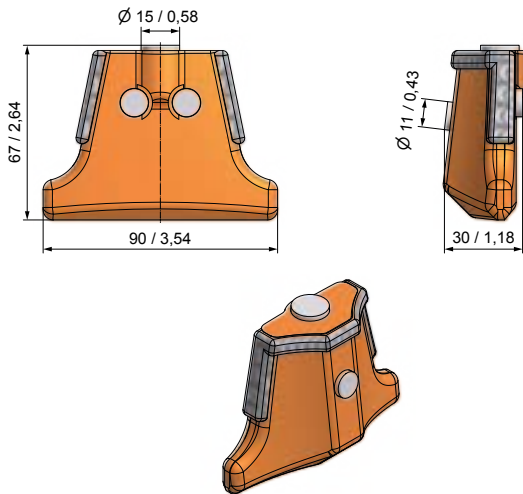

BFZ72 / B
BFZ65x90x30

25



Wechselstollen 30 mm/1,18" Wandstärke Bohrrohr

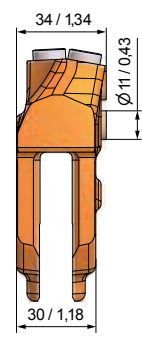
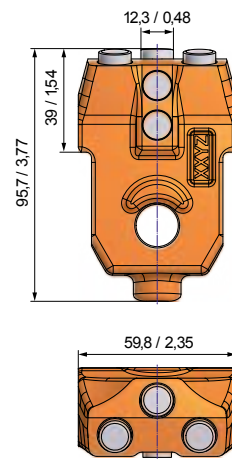
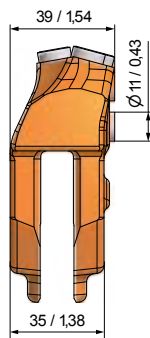
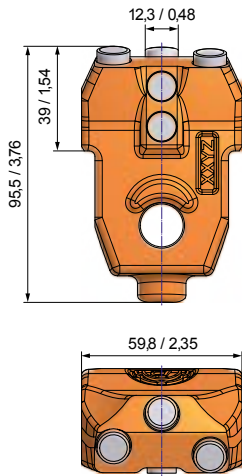

BA58
BA96x60x35



BA60
BA96x60x30

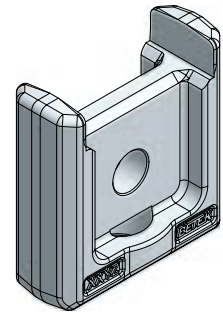
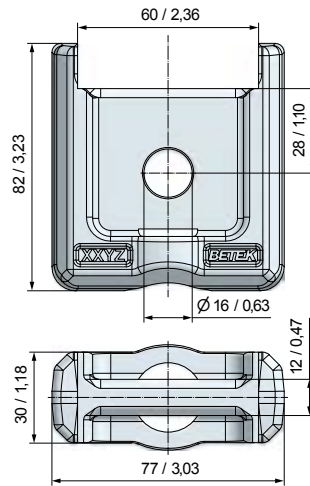
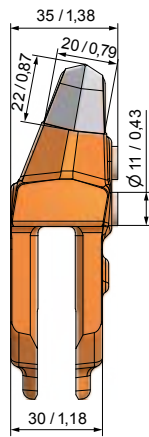
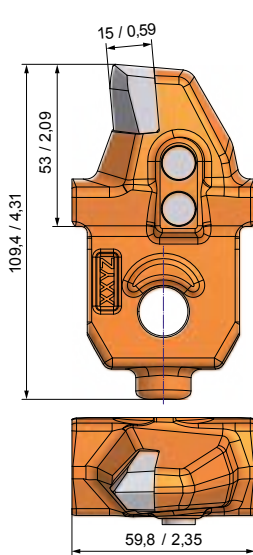

BA61
BA109x60x30



BHA06
BHA77x82x30

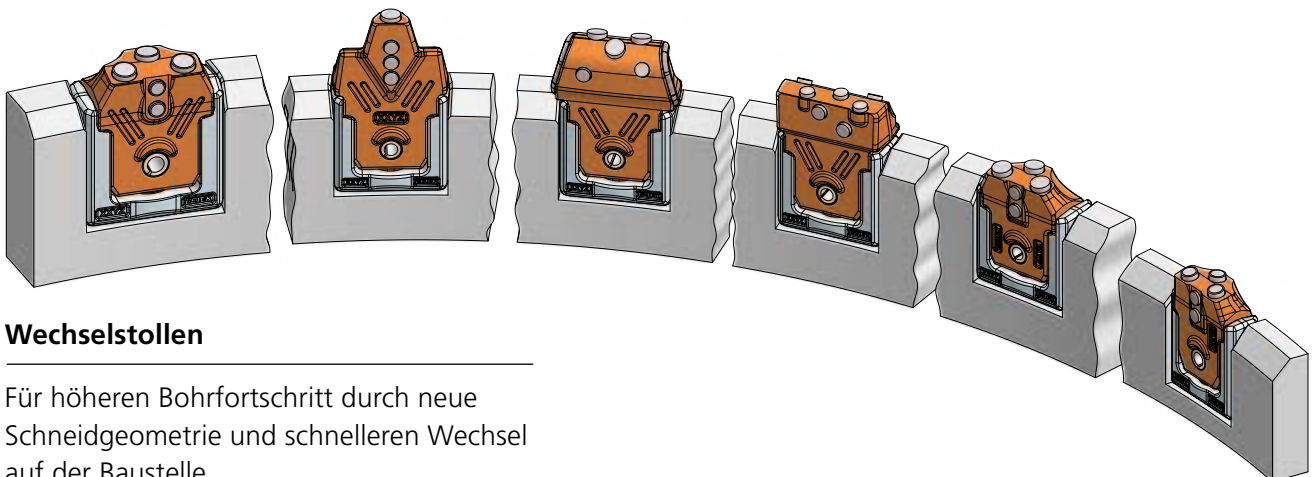

Wechselstollen

Für höheren Bohrfortschritt durch neue Schneidgeometrie und schnelleren Wechsel auf der Baustelle

Wechselstollen 40 mm / 1,58" Wandstärke Bohrrohr

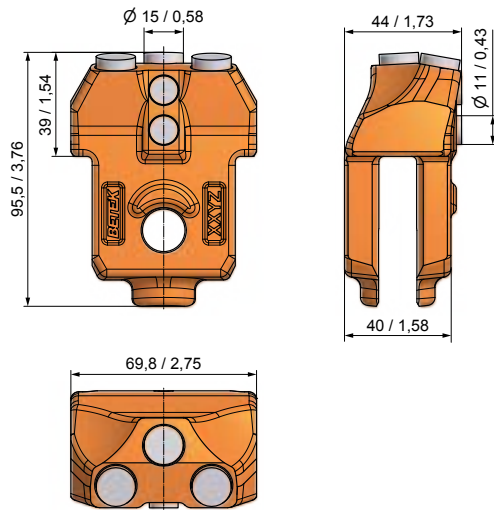

BA47
BA96x70x40

10

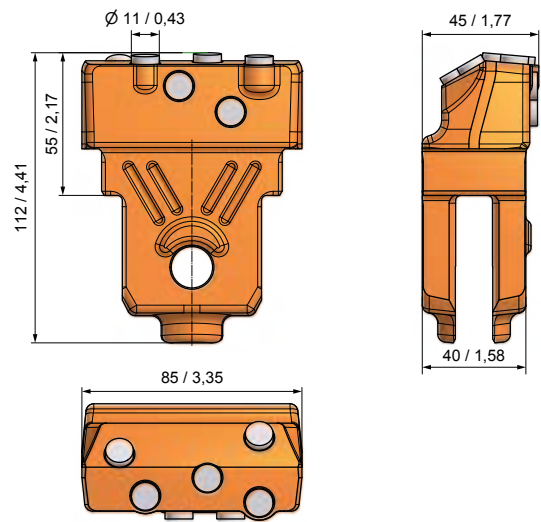

BA50
BA112x85x40

10

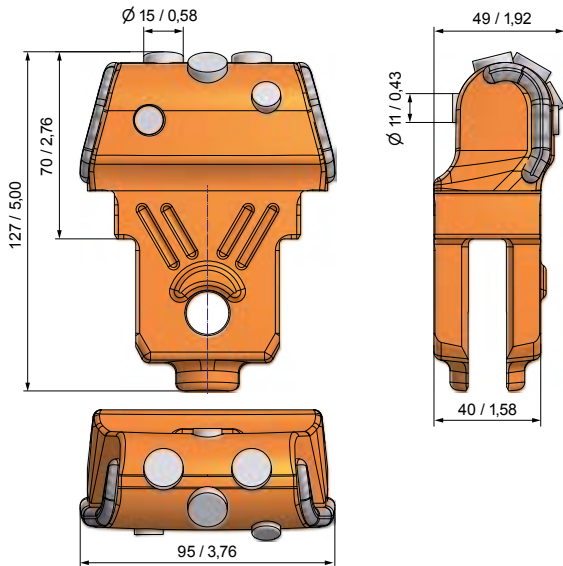

BA51
BA127x90x40

8

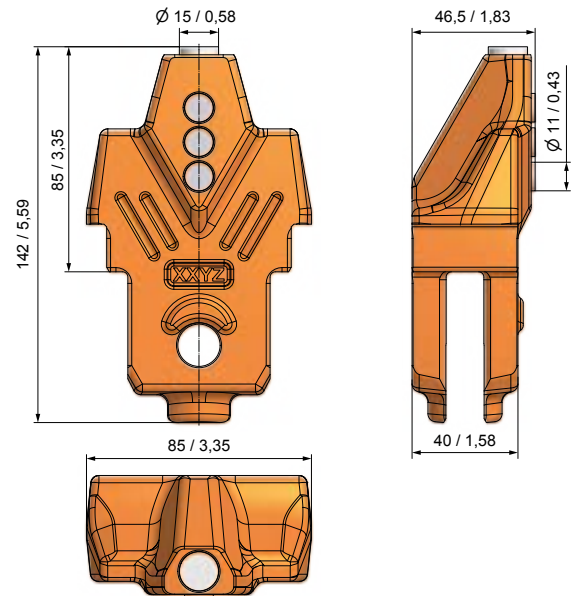

BA52
BA142x85x40

10

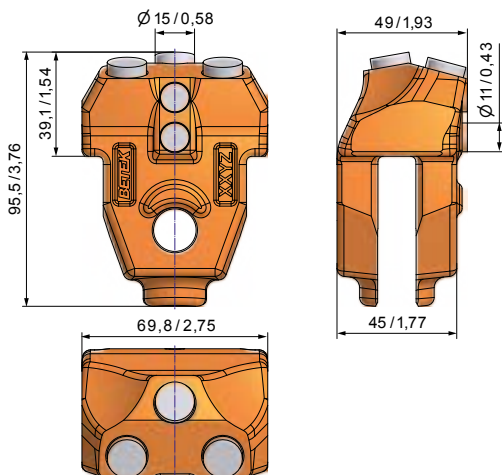

BA57
BA96x70x45

10

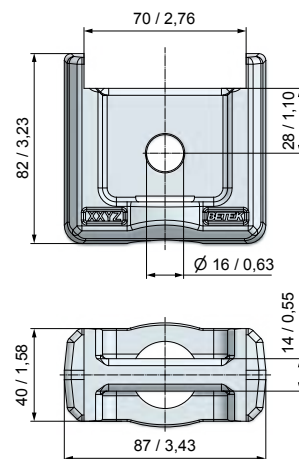

BHA04
BHA87x82x40

10

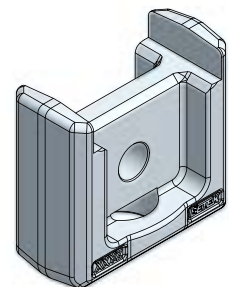

SPH73

Wechselstollen 40 mm / 1,58" Wandstärke Bohrrohr

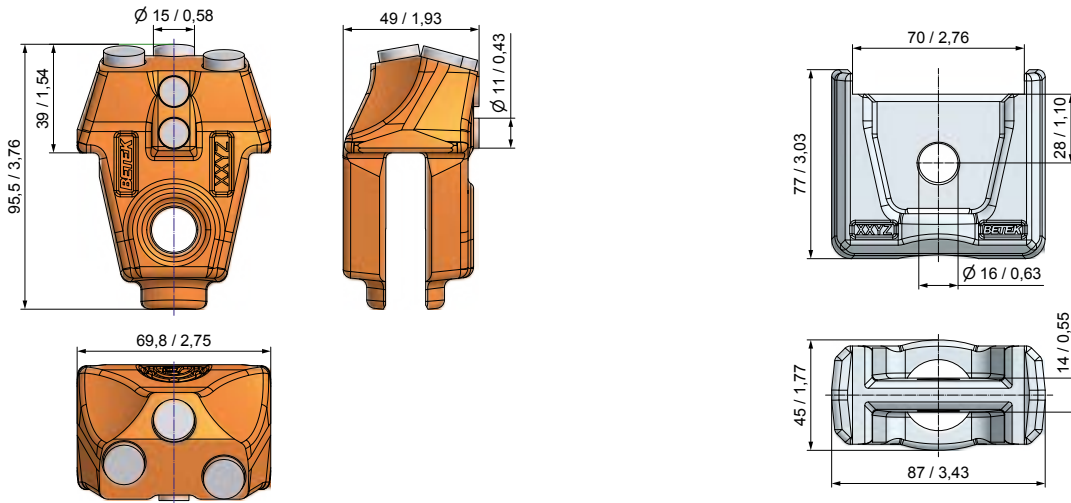

BA63
BA96x70x45



BHA07
BHA87x77x40



Wechselstollen 50 mm / 1,97" Wandstärke Bohrrohr

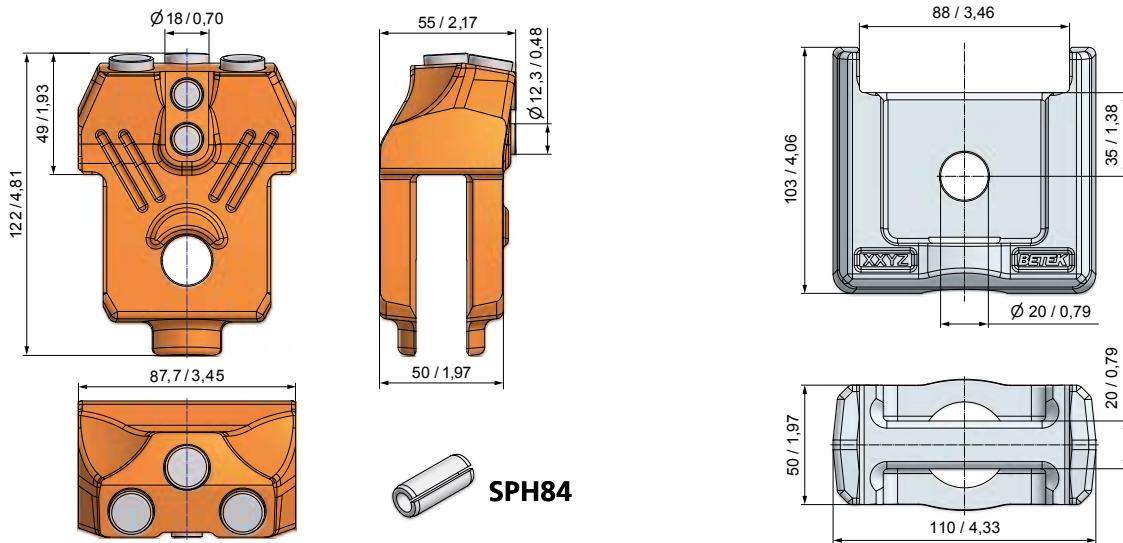

BA53
BA122x88x50



BHA05
BHA110x103x50



Kaliberschut für Bohrschnecken

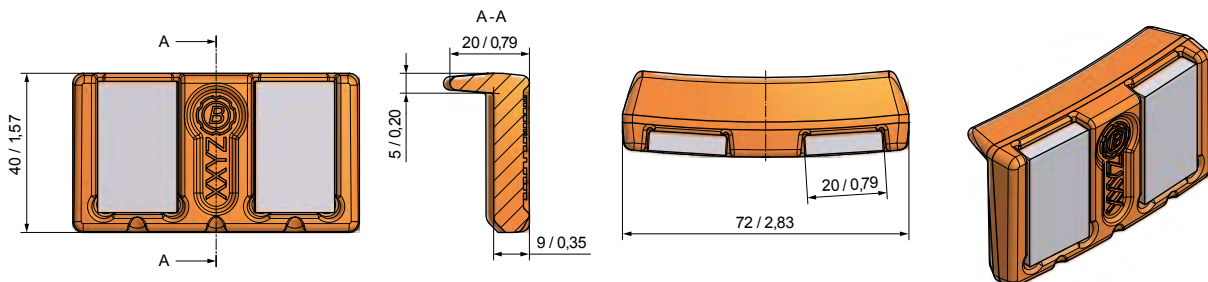

BA54
BA72x40x20



Wechselstollen 40 mm / 1,58" Wandstärke Bohrrohr

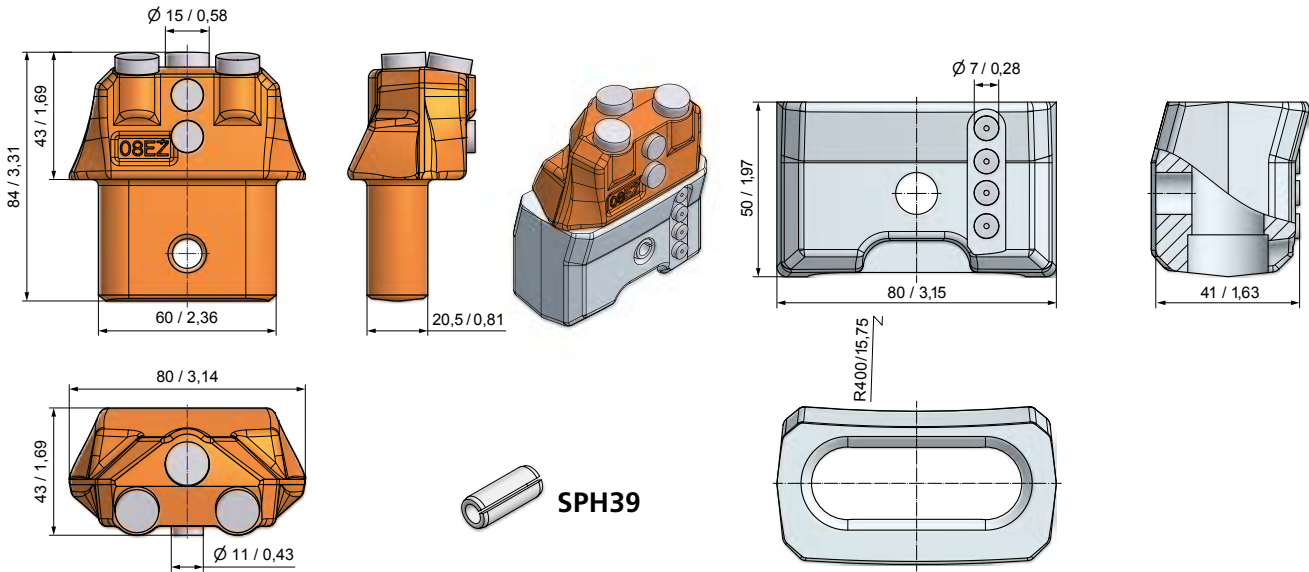

BA46
BA80-31

15

BHA02
BHA60/2

20

Anschweißzähne

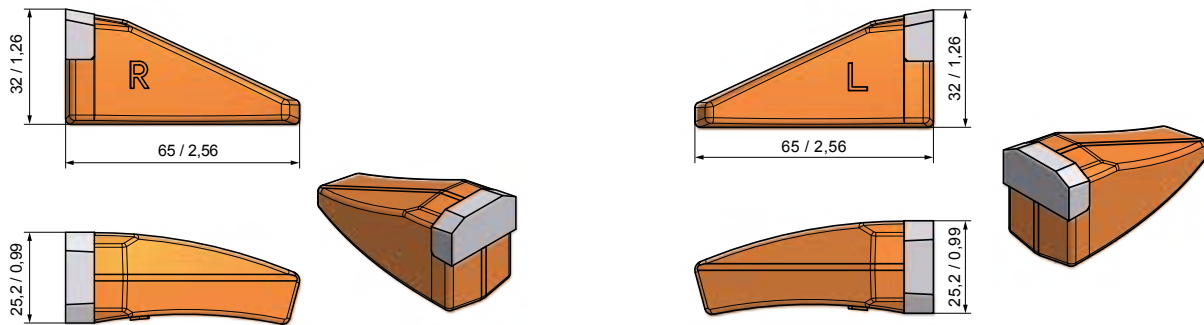

BFZ25R
BFZ25-R

50

BFZ25L
BFZ25-L

50

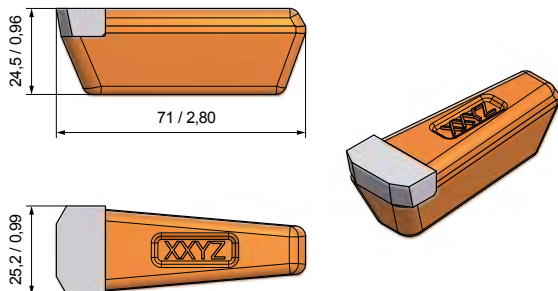

BFZ96
BFZ71x25

50



Anschweißzähne

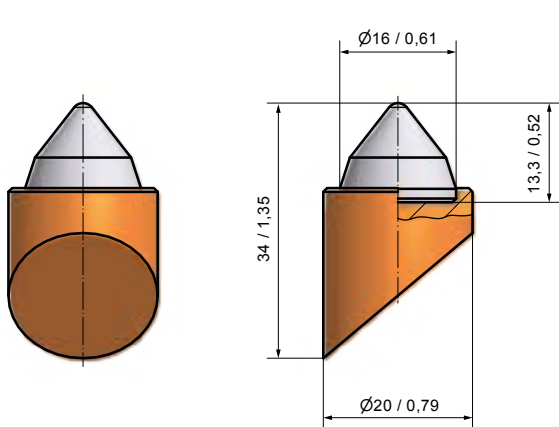

BFZ158
BFZ3 250

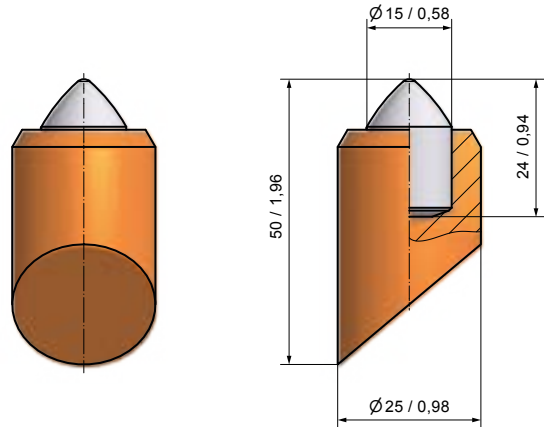

BFZ207
BFZ1 100

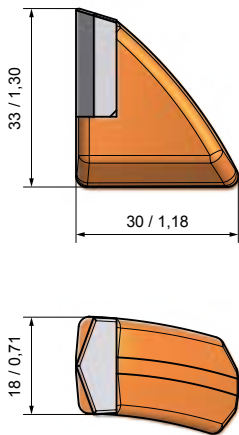

BFZ107
BFZ18/R 200

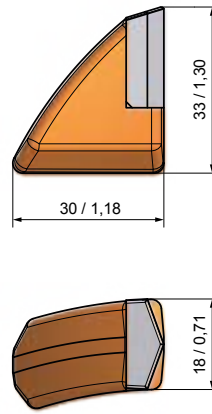

BFZ144
BFZ18/L 200

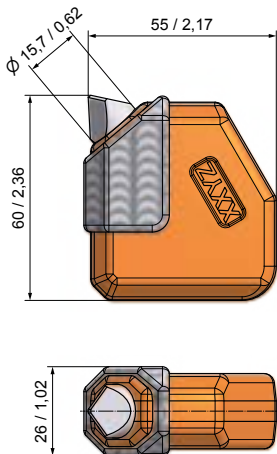

BFZ257
BFZ60x55x22 25

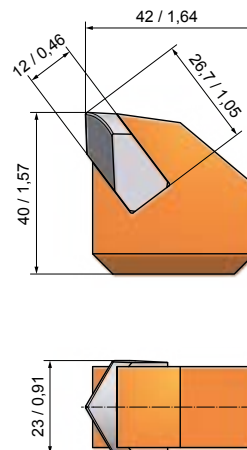

BFZ260
BFZ42x40x23 50

Anschweißzähne

BFZ87
BFZ18/2

50

BFZ319
BFZ75x65x20

25

BFZ318
BFZ46x44x13

100

BFZ321
BFZ32x27x13

100

BFZ320
BFZ44x39x22

50

BFZ326
BFZ38/M

25

Dragon Tooth

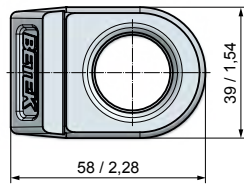
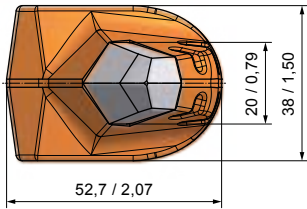
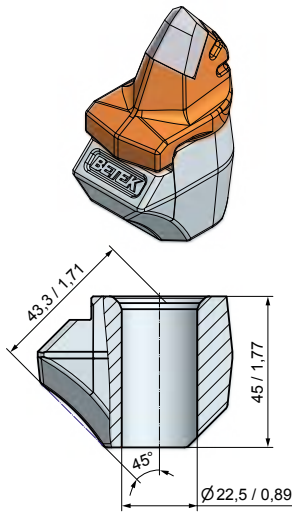
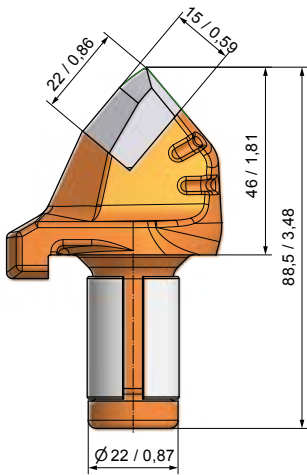
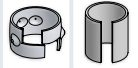

BFR07

40

BFR46-22

BHR133

40

B10/22-F

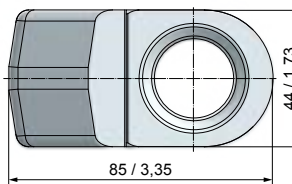
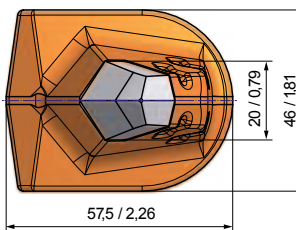
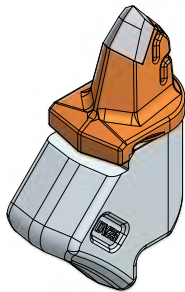
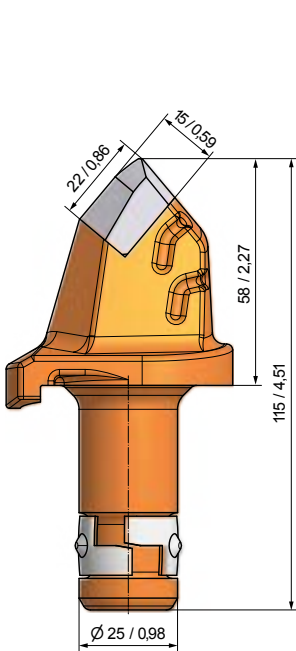

BFR08

25

BFR58-25

BHR184

15

DV25-F

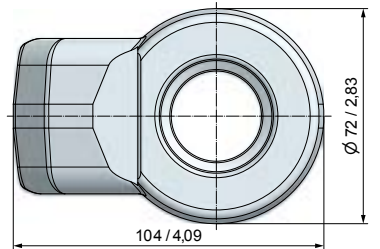
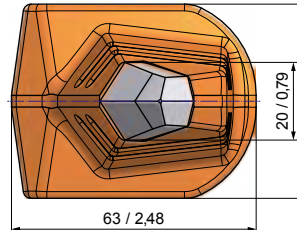
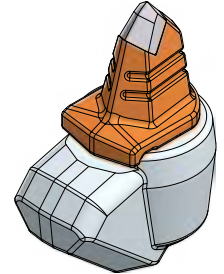
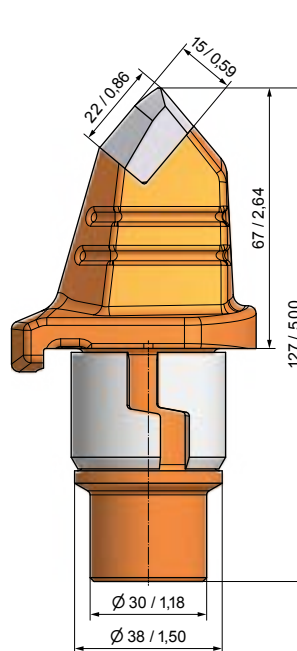

BFR10

15

BFR67-38/30

BHR244

15

B43K-F

Flachzähne

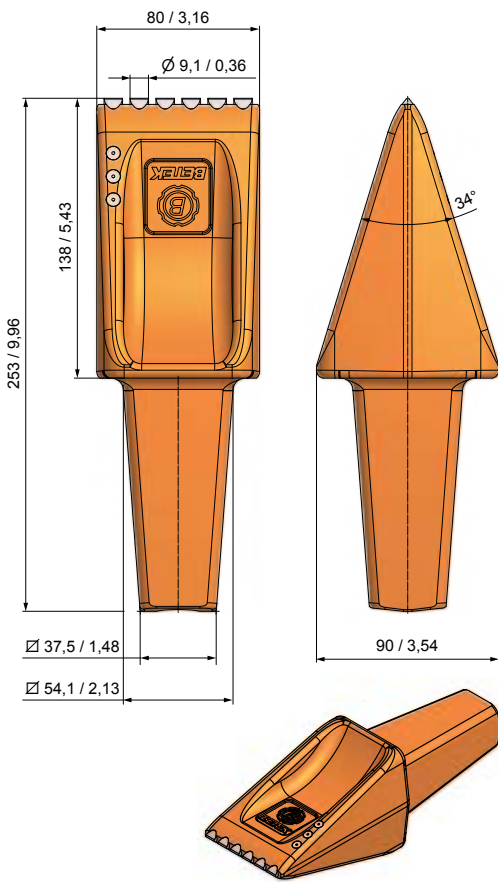

BFZ317
BFZ80-B

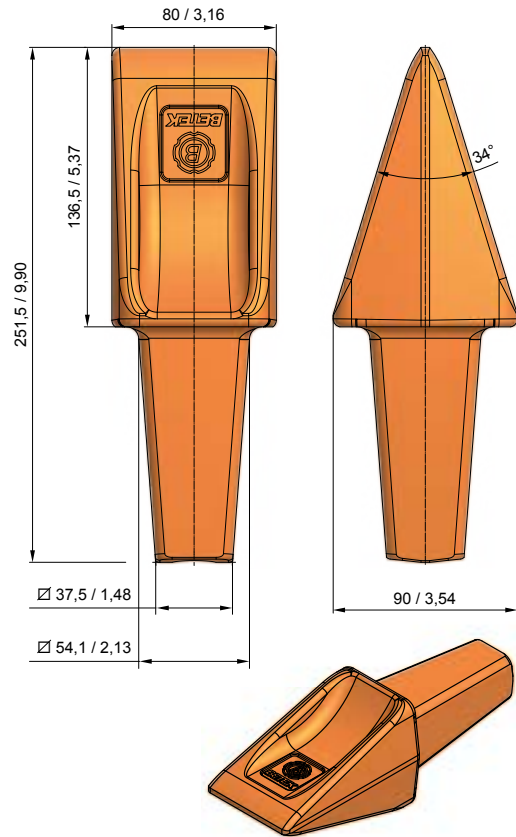

BFZ79
BFZ80OHM

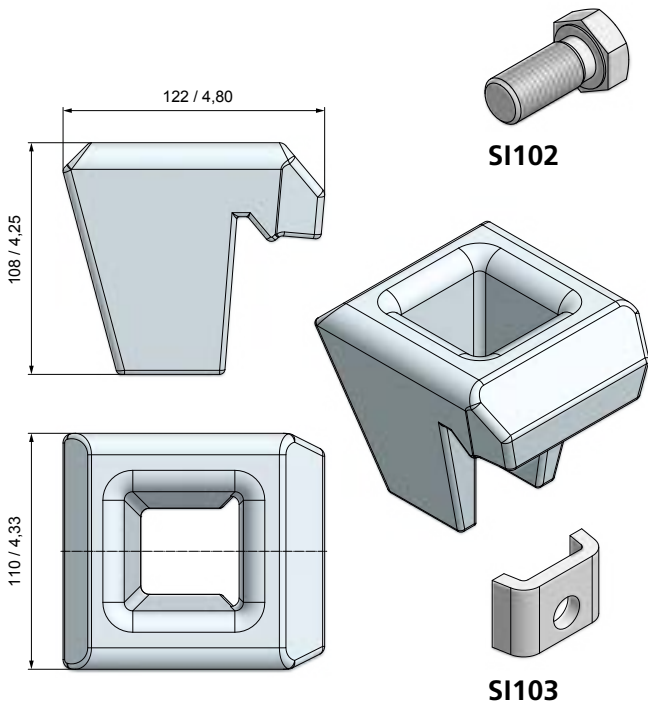

BHR73
BHZ80/2



Flachzähne

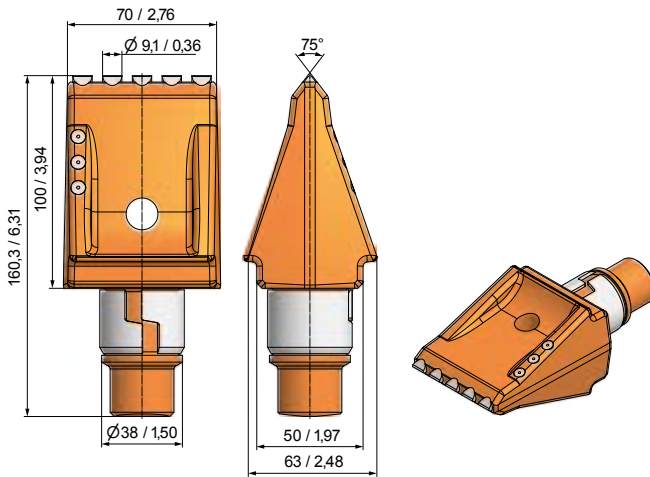

BFZ162
BFZ100x70/2

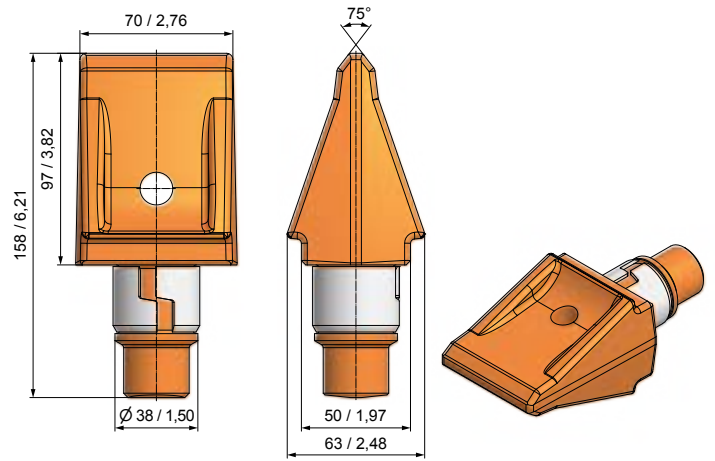

BFZ69
BFZ100x70

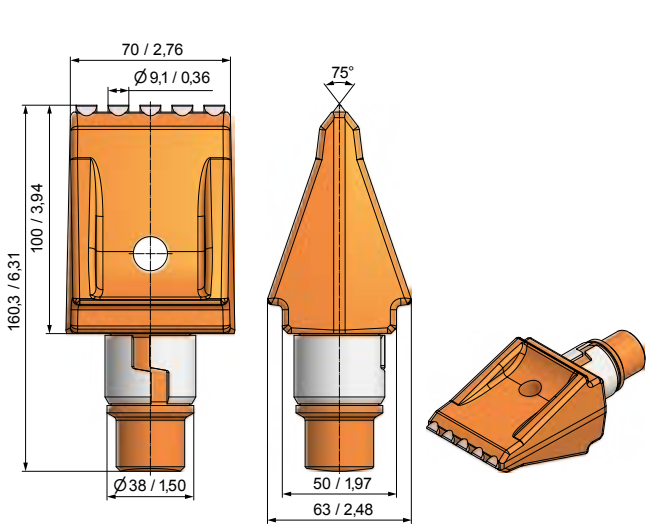

BFZ339
BFZ100x70/4

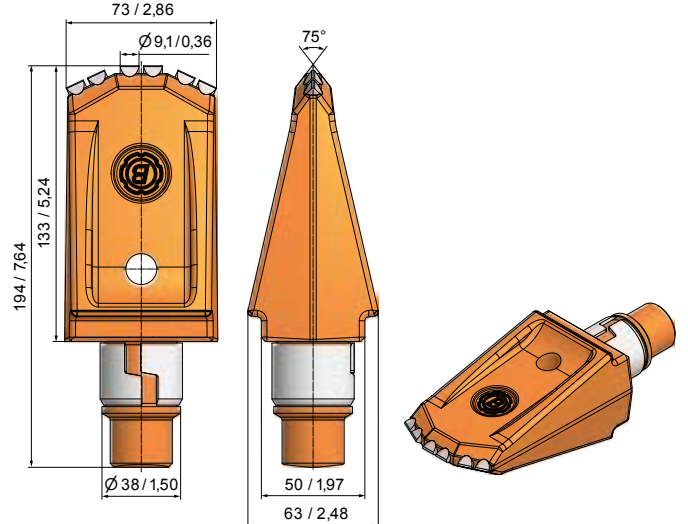

BFZ322
BFZ133x73/HM

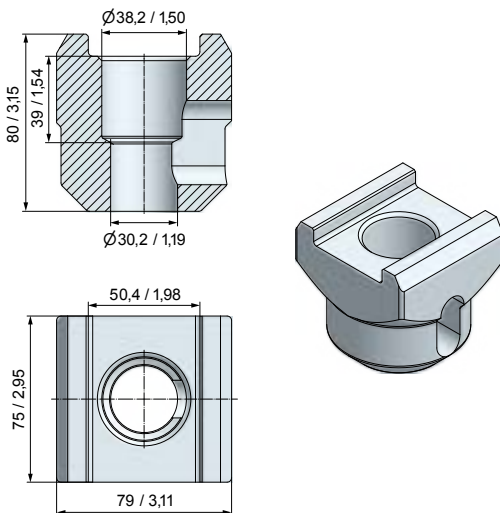

BHR112
B75

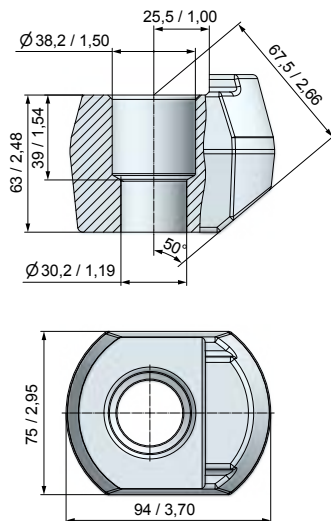

BHR39
B48



Flachzähne

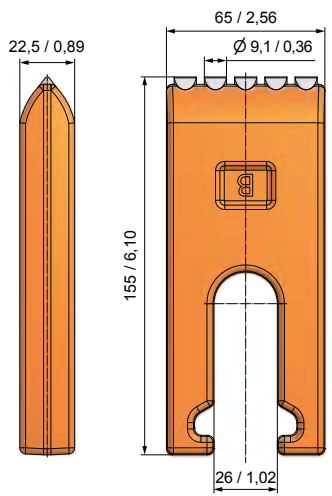

BFZ65HM
BFZ65/2

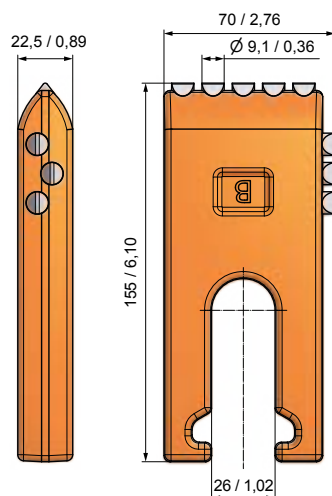

BFZ02
BFZ65/3

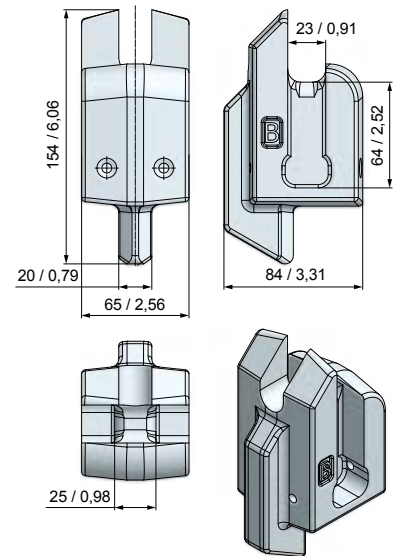

BHF02
B65-22

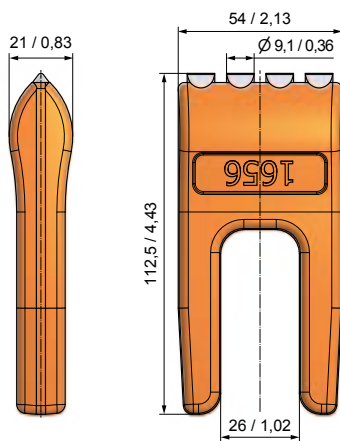

BFZ05N
BFZ1656N

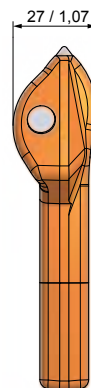

BFZ198N
BFZ1658N

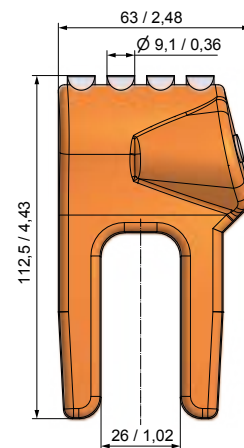

BFZ200N
BFZ2077N



BFZ218
BFZ2078

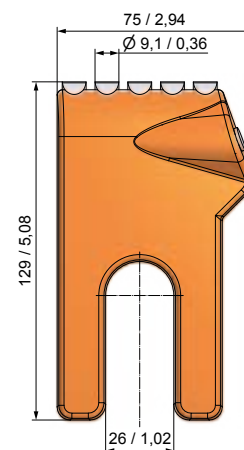

Flachzähne

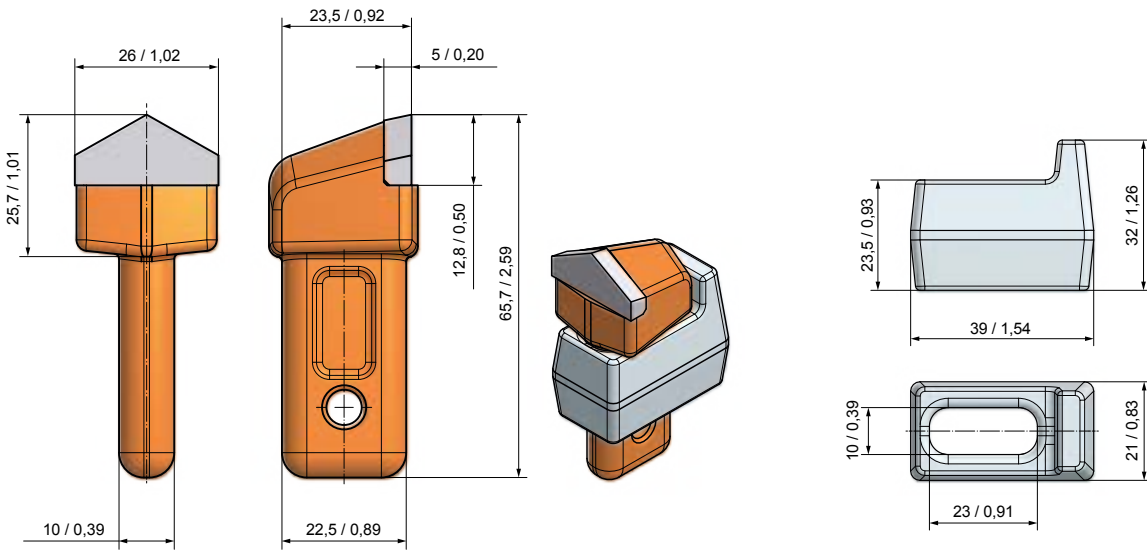

BFZ272

BFZ67x30x26



BHZ24

BHZ39x32x21

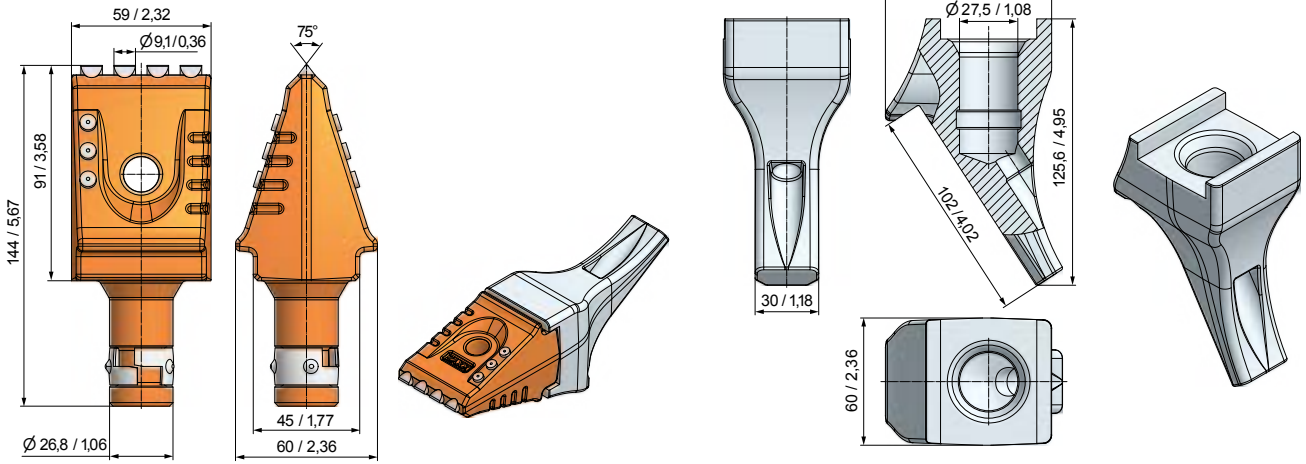

BFZ324

BFZ91x59



BHR220

B27.60



Piloten

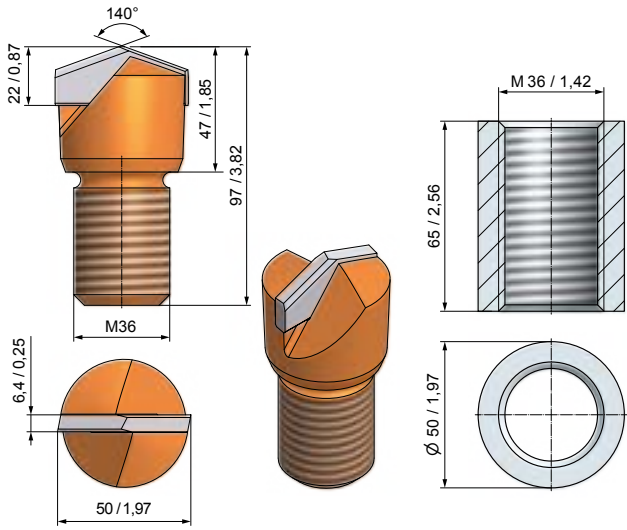

BP04 20
BP51/M36-HD3

BPH01 20
GH-M36

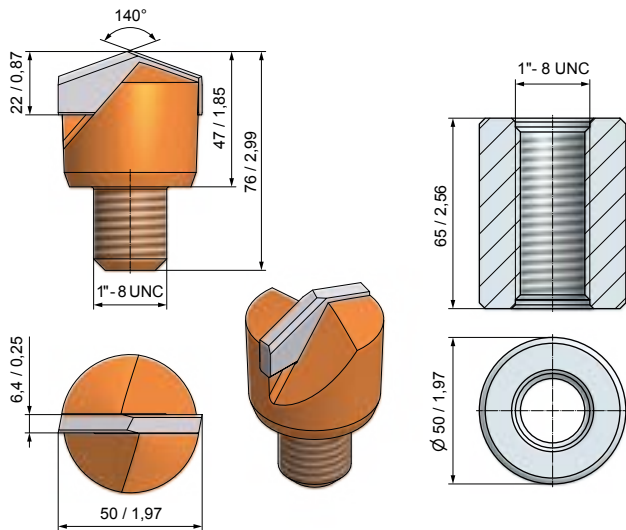

BP01 20
BP51/1"-HD3

BPH02 20
GH-1"

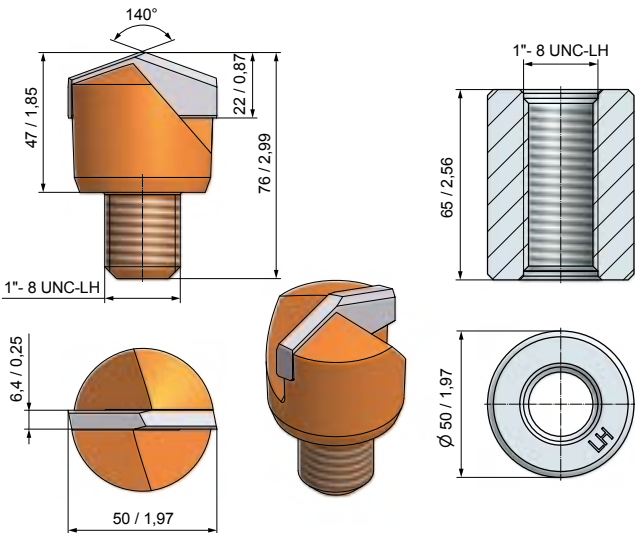

BP10 20
BP51/1"-HD3/LH

BPH03 20
GH-1"LH

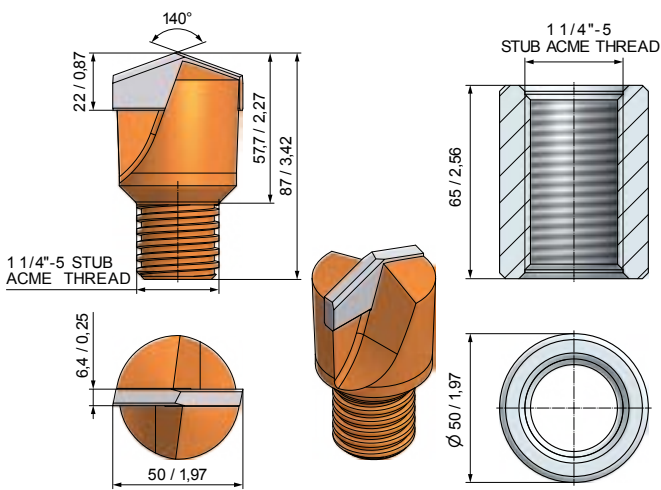

BP51 20
BP51x87

BPH04 20
GH-1 1/4"-5



Schaftsystem Ø 11,3 mm/0,44"

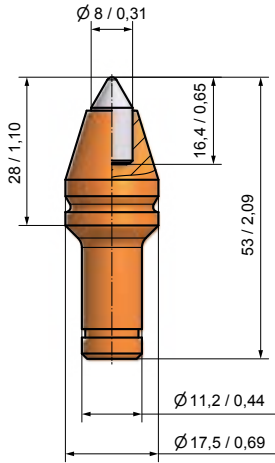

BM11

200

BM8-11.3

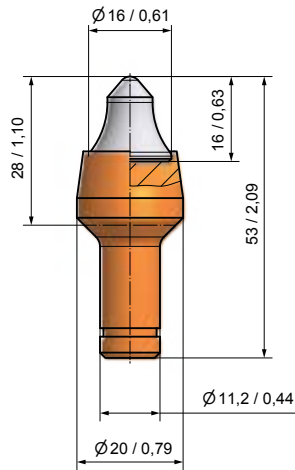

BM10

200

BM4-11.3

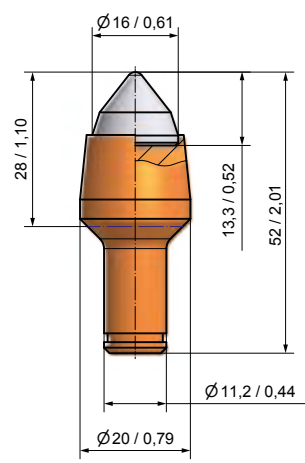

BM46

200

BM3-11.3

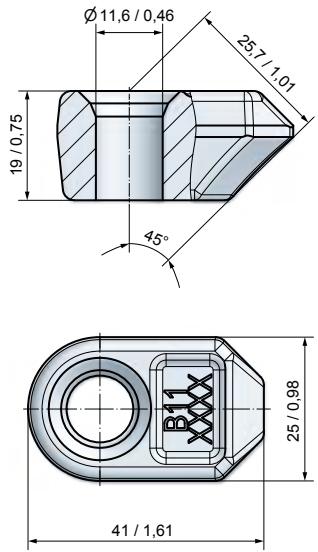

BHR03

200

B11

Schaftsystem Ø 13 mm/0,52"

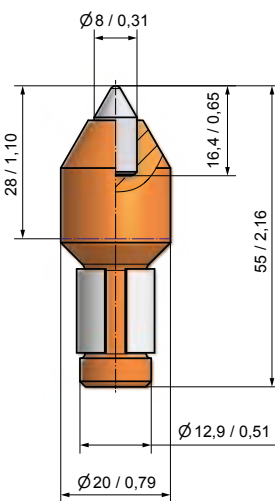

BM34

200

BM8-13/H

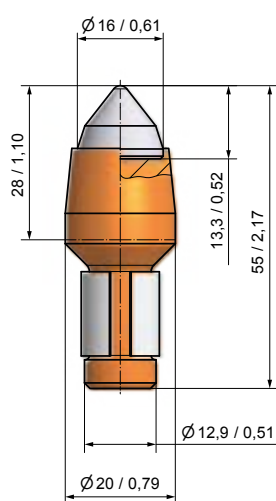

BM62

200

BM3-13/H

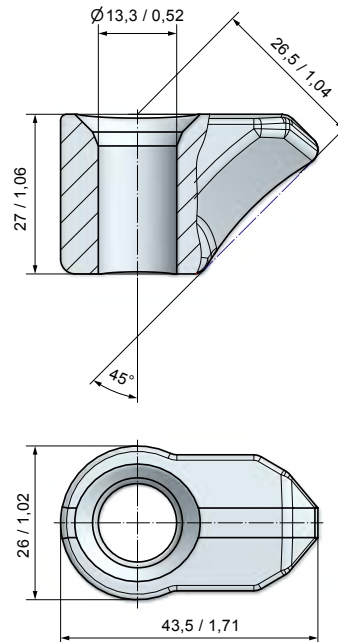

BHR47

150

B13

Schaftsystem Ø 14 mm/0,55"

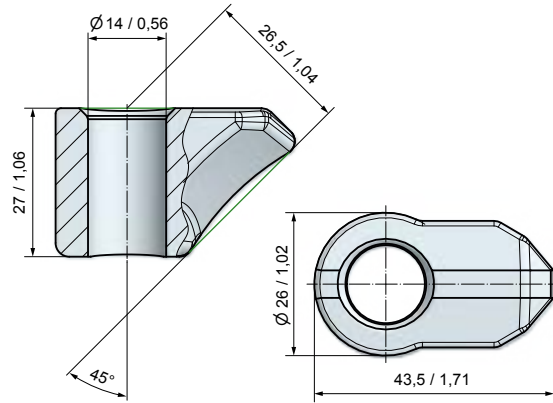
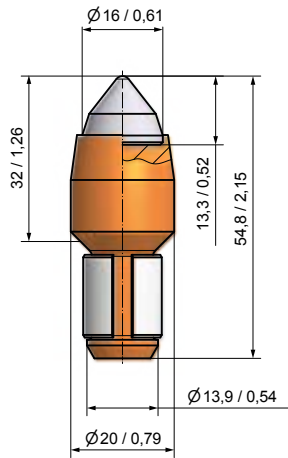
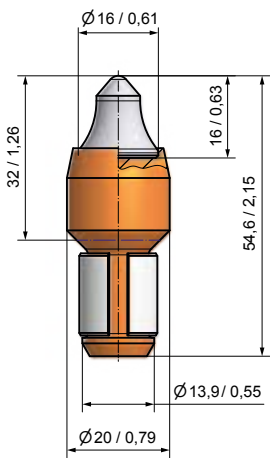

BM55

200

BM4-14/2

BM60

200

BM3-14/H

BHR109

150

B14

Schaftsystem Ø 18,7 mm/0,74"

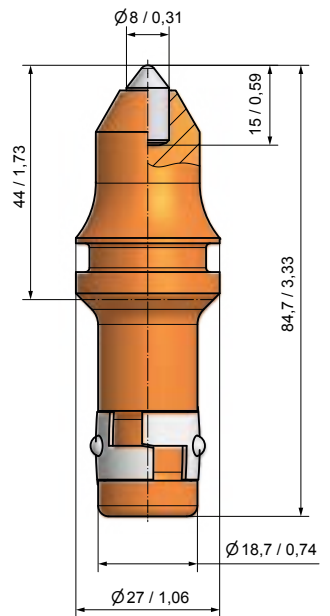
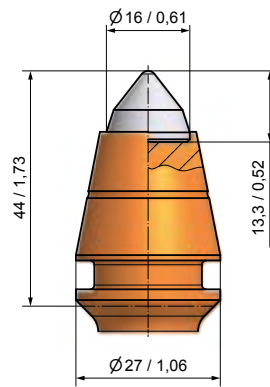
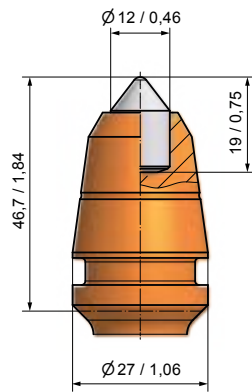
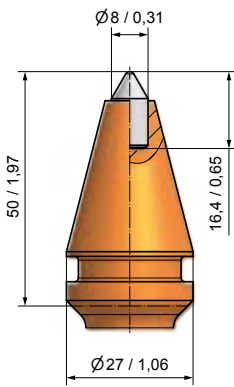

BTR08

75

B43K8S

BTR02

50

B43HDK12

BTR03

50

B43/3

BTR01

50

B43K8

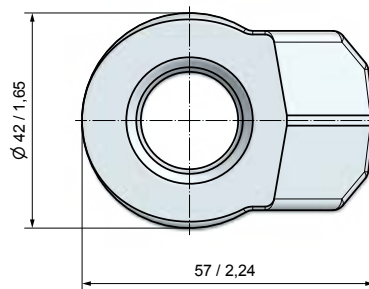
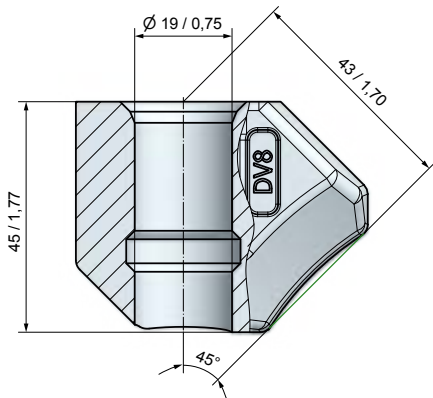

BHR20

40

DV8

Schaftsystem Ø 19,4 mm/0,76"

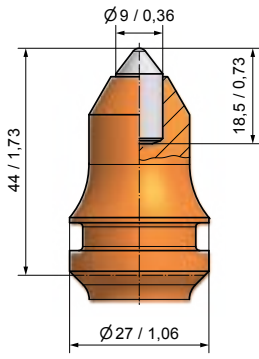
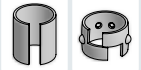

BSK15
B1K9-K

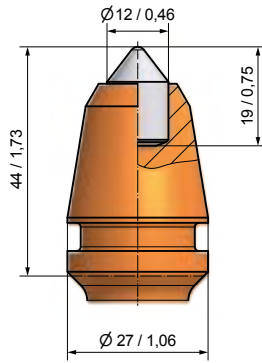

BSK17
B1HDK12-K

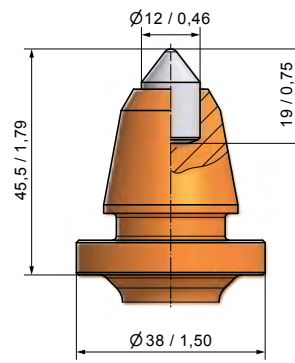

BSK21
B1-12/38-K

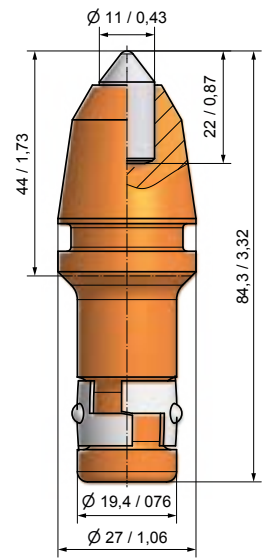

BSK16
B1HDK11-K

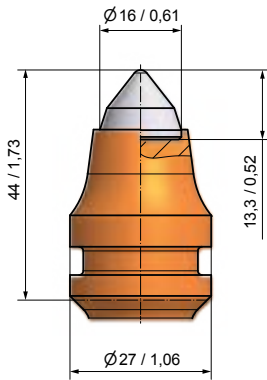

BSK12
B3-K

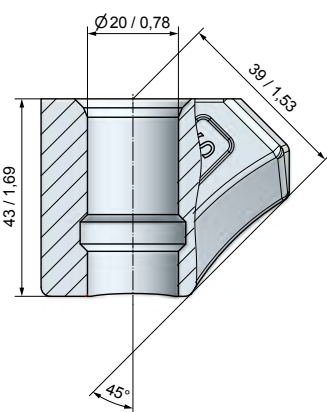

BHR164
DV9-S

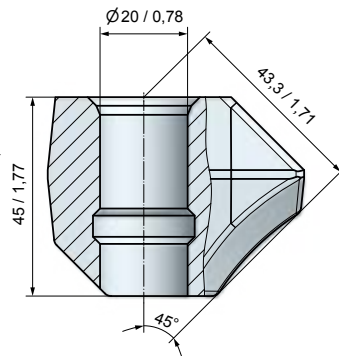

BHR07
DV9

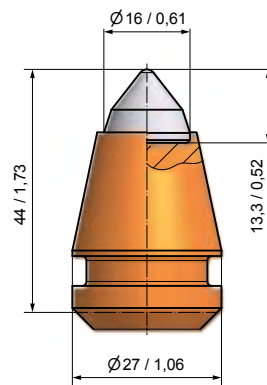

BSH09
B3

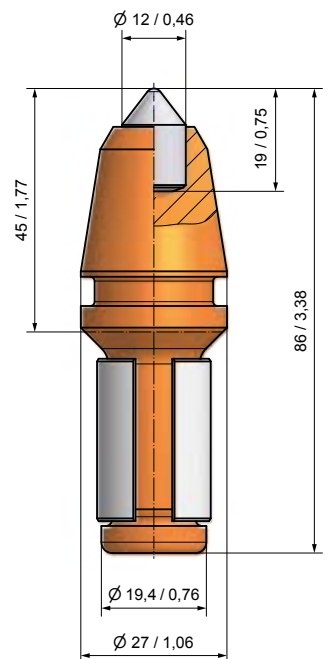

BSH05
B1HDK12



Schaftsystem Ø 25 mm / 1"

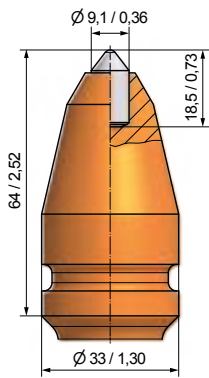

BTK01
B40K9

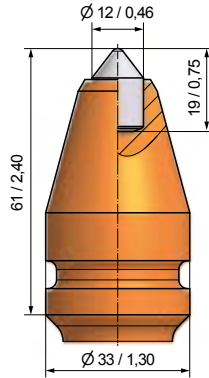

BTK03
B40HDK12

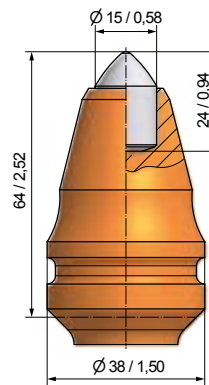

BTK10
B40HDS

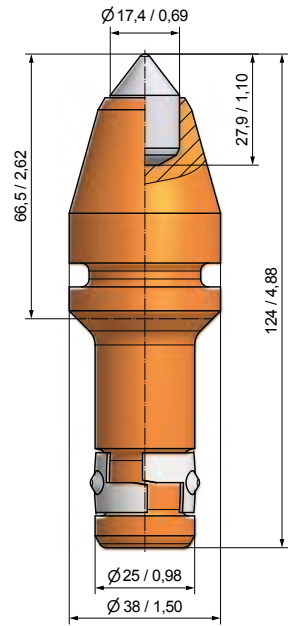

BTK70
B40K17.5

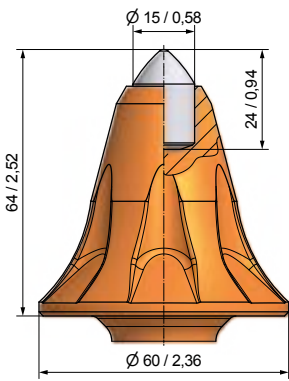

BTK81
B40HDS/60

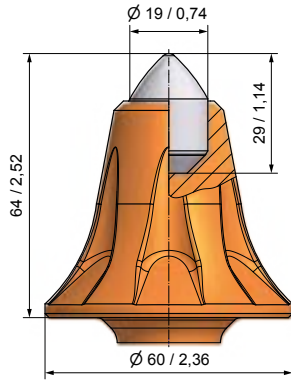

BTK89
BG25K-19.6064

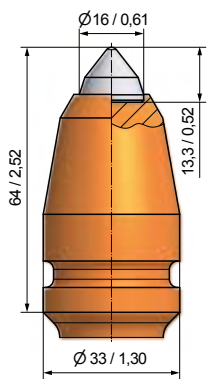

BTK16
B40/3

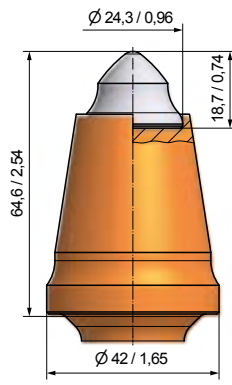

BTK87
B40/9

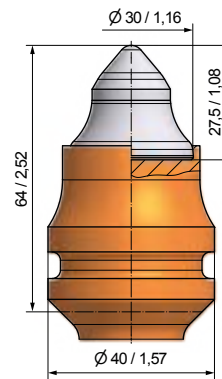

BTK23
B40HBL

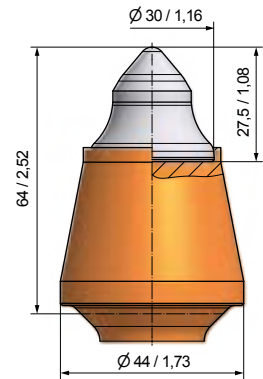

BTK26
B40-J1-HBL



Schaftsystem Ø 25 mm / 1"

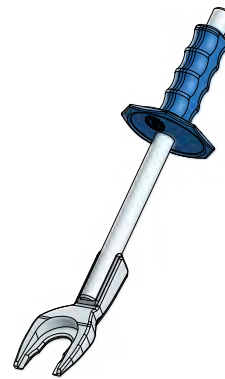
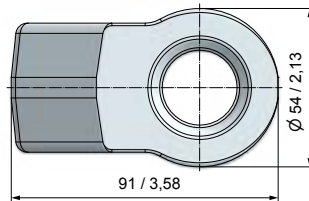
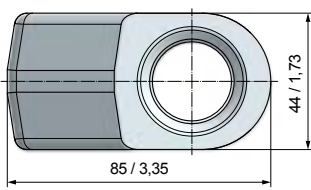
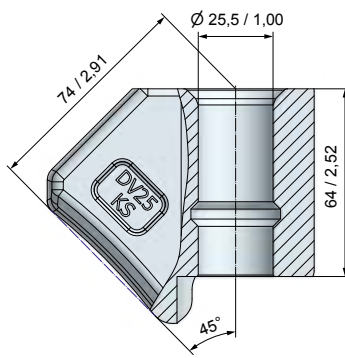
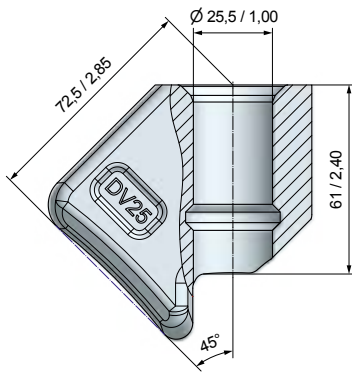

BHR31
DV25



BHR121
DV25KS



BZ22
Meißelauszieher



Schaftsystem Ø 38/30 mm - 1,5/1,18"

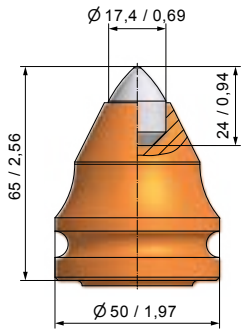

BKH140
B47K17.5-H/2



15

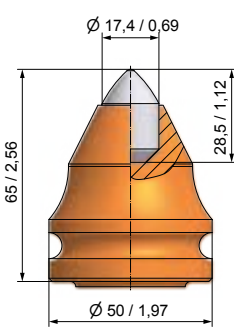

BKH28
B47K17.5-H



15

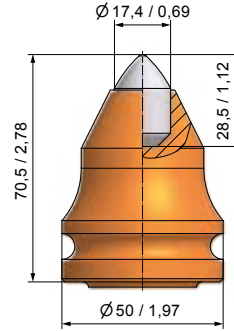

BKH80
B47K17.5LK70-H



15

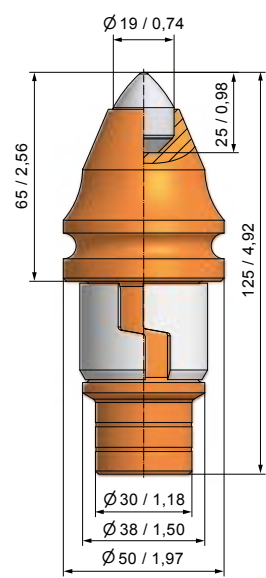

BKH83
B47K19-H/2



15

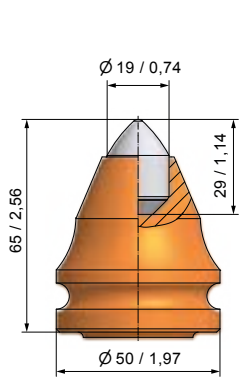

BKH40
B47K19-H



15

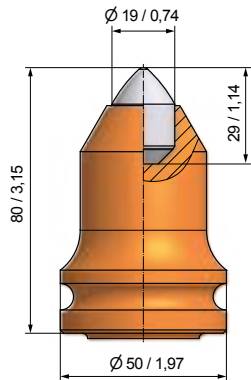

BKH41
B47K19LK80-H



15

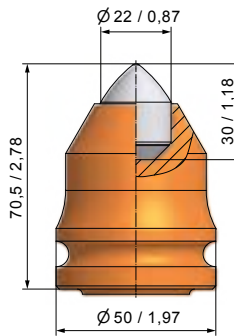

BKH85
B47K22-H/2



15

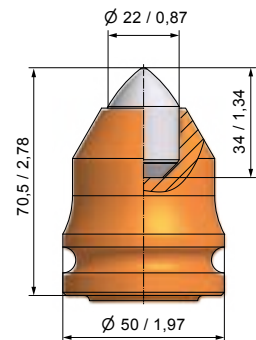

BKH47
B47K22-H



15

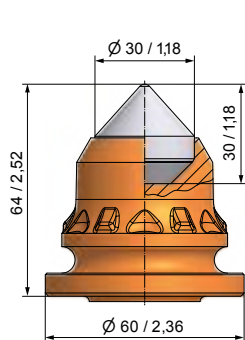

BKH92
BS38H-30.6064



10

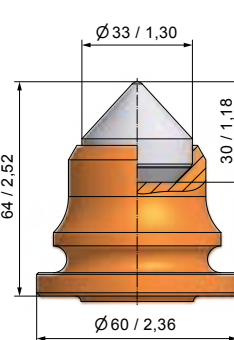

BKH84
B47K33/60-H



10

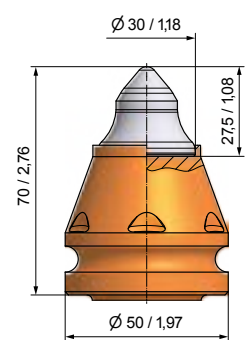

BKH101
BS38H-69.5070



15

Schaftsystem Ø 38/30 mm - 1,5/1,18"

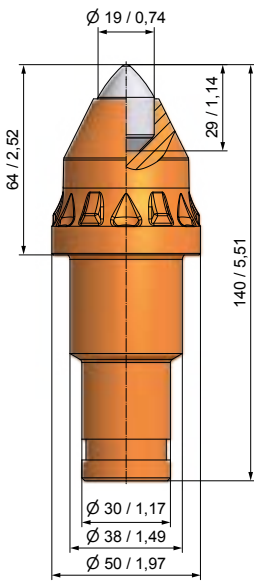

BKS154 10
BS38W-19.5064

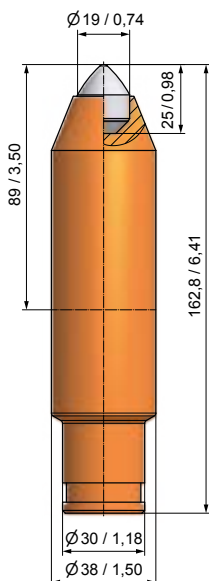

BKS186 15
BS38W-19.3889

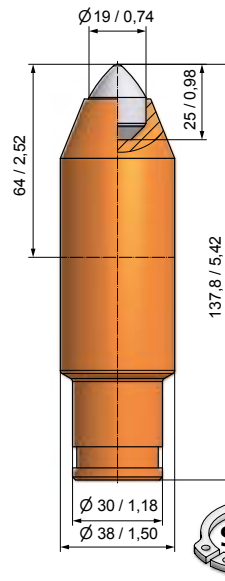

BKS187 15
BS38W-19.3864

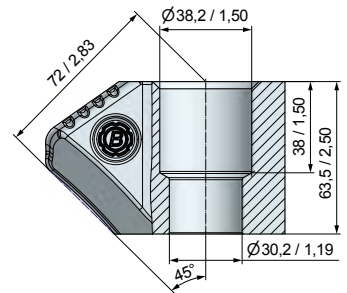

BHR38 10
B43H

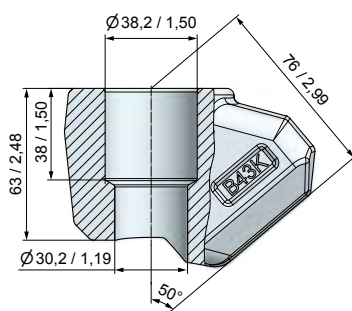

BHR113 6
B43K

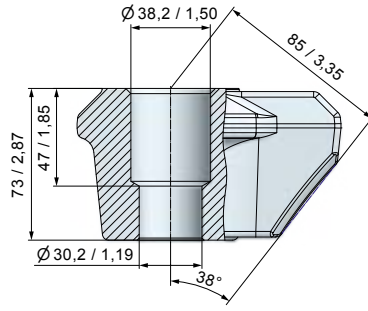

BHR77 5
B320

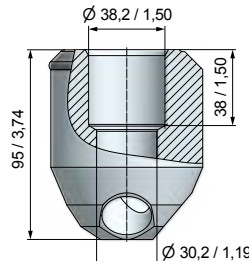

BHR163 6
B76/P

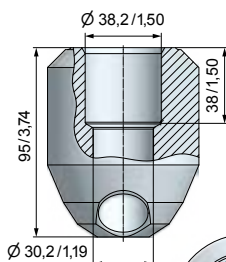
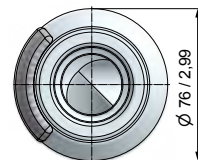
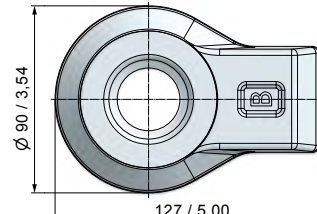
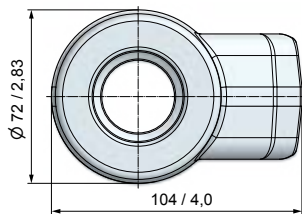
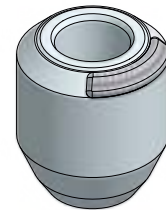

BHR216 6
B76

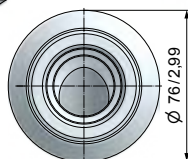

BZ12
Meißelauszieher



BZ18
Meißelauszieher mit Kupferscheibe



Bohrrohrverschraubungen

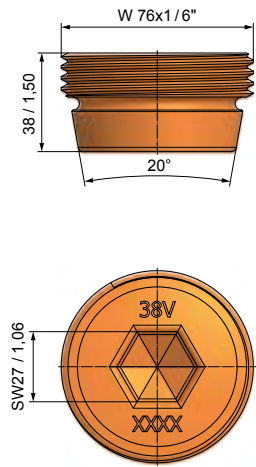

BRV08 15
BRV75/38LV

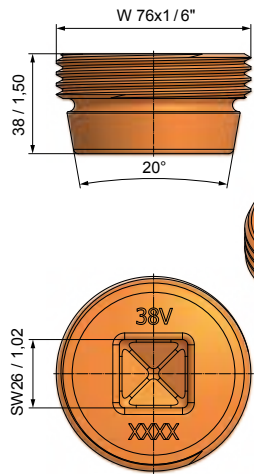

BRV10 15
BRV75/38LV/4

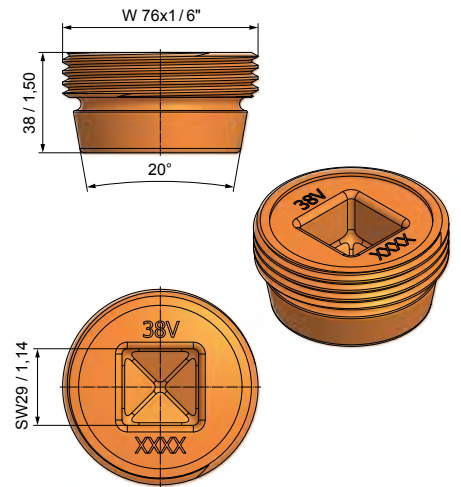

BRV23 15
BRV75/38LV/4/29

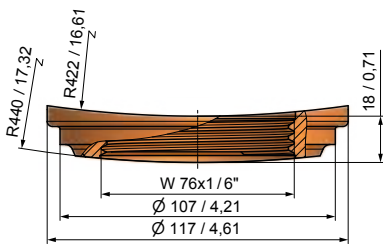

BRV02 15
BRV-G88/L

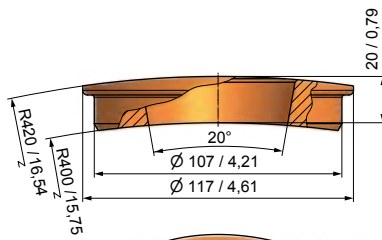

BRV03 15
BRV-K88/L

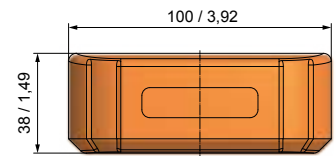

BRV32 15
BRV-AK

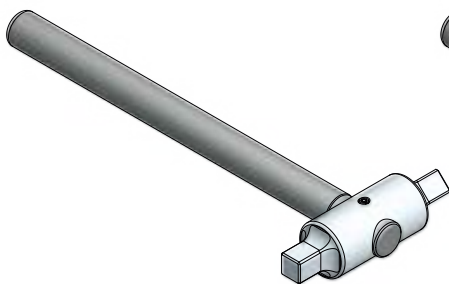
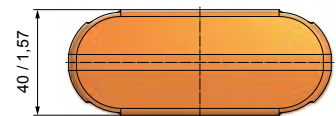
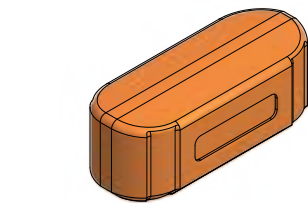

BRV34
BRVSW26

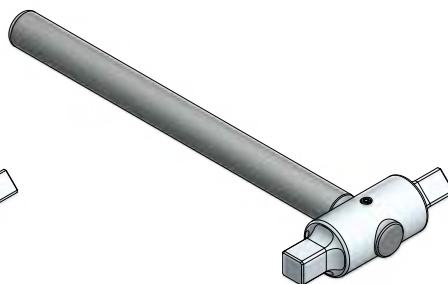

BRV35
BRVSW29

Bezeichnung	Verwendung/ Info	Artikel-Nr.
Bohrrohrverschraubungen für Wandstärke 30 mm		
BRV-G46-14	d=460	BRV19
BRV-K46-14	d=460	BRV18
BRV60/29/4	–	BRV20
Bohrrohrverschraubungen für Wandstärke 40 mm		
BRV-G64/B	d=620 - 640	BRV04
BRV-K64/B	d=620 - 640	BRV05
BRV-G64/L	d=620 - 640	BRV14
BRV-K64/L	d=620 - 640	BRV15
BRV-G88/L	d=880	BRV02
BRV-K88/L	d=880	BRV03
BRV-G118/L	d=1180	BRV06
BRV-K118/L	d=1180	BRV07
BRV-G150/L	d=1500 - 1800	BRV12
BRV-K150/L	d=1500 - 1800	BRV11
BRV-G80-100-B	d=800 - 1000	BRV30
BRV-K80-100-B	d=800 - 1000	BRV31
BRV75/38LV	(6kt.SW27)	BRV08
BRV75/38LV/4	(4kt.SW26)	BRV10
BRV75/37/12°/BV	–	BRV16
BRV75/38LV/4	(4kt.SW29)	BRV23
O-Ring 5x60	–	SI116
Bohrrohrverschraubungen für Wandstärke 50 mm		
BRV75/48/4	–	BRV17
BRV-G140-23	d=1400 - 1500	BRV21
BRV-K140-24,5	d=1400 - 1500	BRV22
Sonstiges		
BRV-AK	(Arretierkeil)	BRV32

Zähne für Schlitzwandfräsen

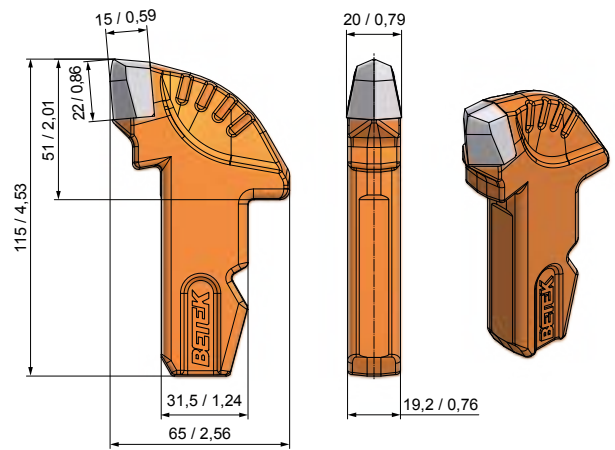
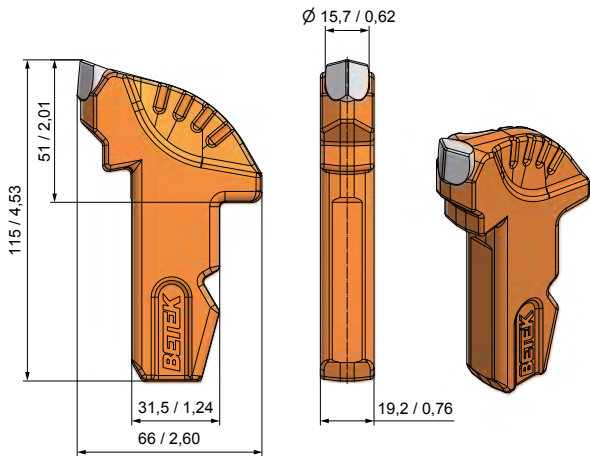

BF40
BF115x32x19

25

BF41
BF115x32x19/1

25

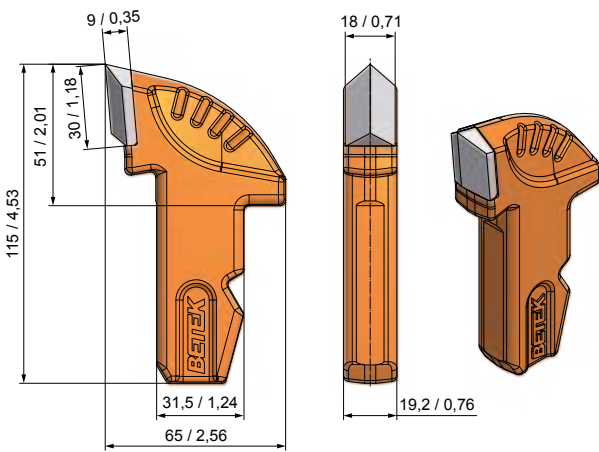

BF42
BF115x32x19/2

25

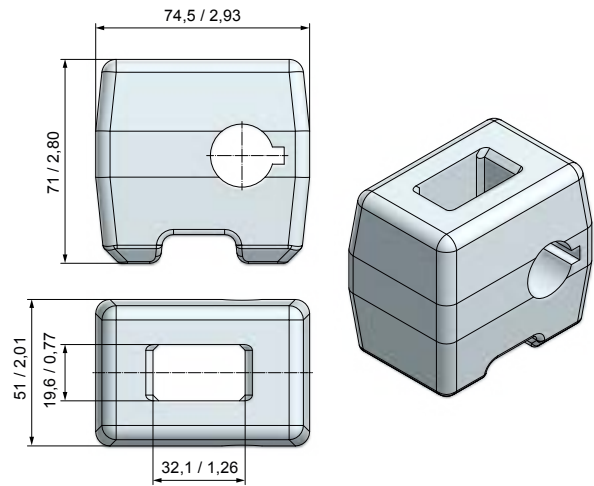

BHF15
BHF32x20

10

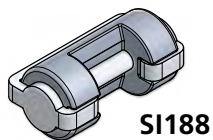

S1188

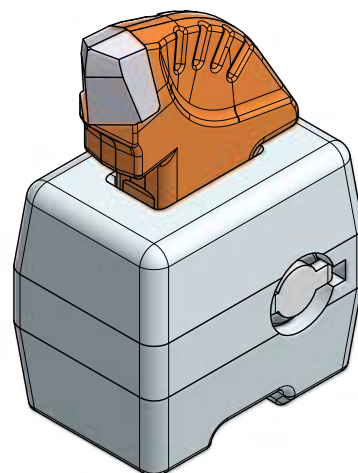

BETEK TungStuds mit Hartmetallkern: wirkungsvoller Verschleißschutz für Metallflächen

BETEK TungStuds sind an vorderster Front, wenn Material gefördert oder bearbeitet wird. Die mit Hartmetallkern ausgestatteten TungStuds kommen zuerst mit dem Fördergut in Kontakt und sind extremer Abrasion ausgesetzt. Zusätzlich zum Verschleißschutz durch die TungStuds wird das gebundene Fördergut als Materialpolster genutzt. Dadurch reduziert sich der direkte Abrieb der Metallfläche durch Materialbewegungen.

Statt teurer Ersatzteile, die aufgrund von abgenutzten Metallflächen fällig werden, müssen nur die TungStuds erneuert werden. Zudem fällt beim Einsatz von BETEK TungStuds weniger Wartungsaufwand an, da sie dank Hartmetallkern extremsten Bedingungen standhalten.

Weitere Informationen: www.betek.de/de/produktprogramm/tungstuds



* Höhe nach dem Anschweißen

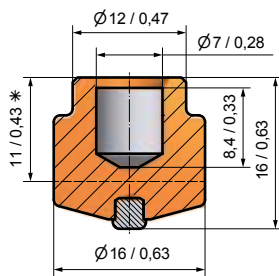

BTS01

150

BTSD16/16

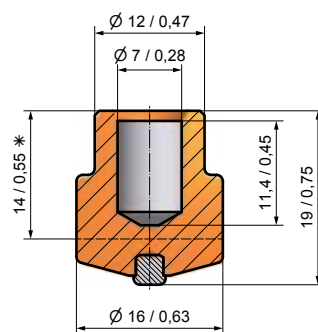

BTS02

150

BTSD16/19

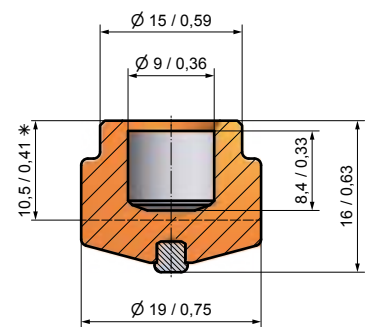

BTS03

150

BTSD19/16

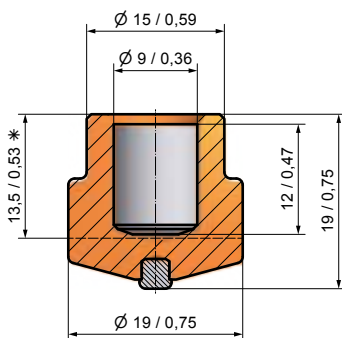

BTS04

150

BTSD19/19

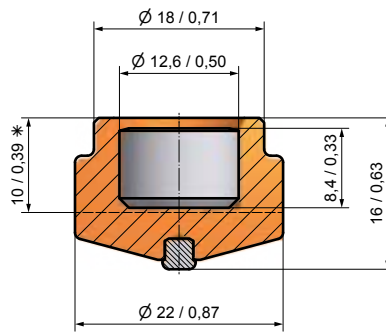

BTS05

100

BTSD22/16

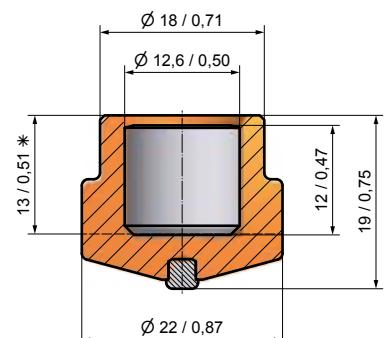

BTS06

100

BTSD22/19

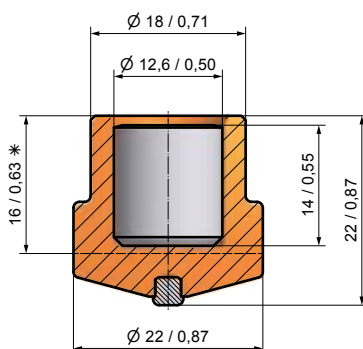

BTS07

100

BTSD22/22

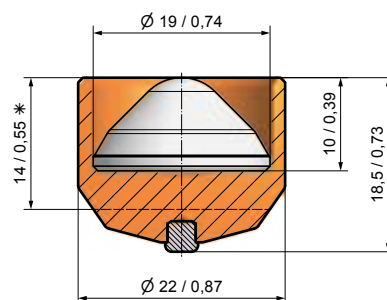

BTS08

100

BTSD22/18.5SG

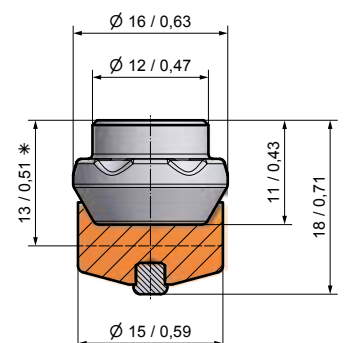

BTS10B

150

BTSD16/18B



D

BETEK GmbH & Co. KG

Sulgener Str. 21 - 23
D-78733 Aichhalden

Service-Nummer + 49 (0) 74 22 / 5 65-591
Service-Fax + 49 (0) 74 22 / 5 65-122

info@betek.de
www.betek.de

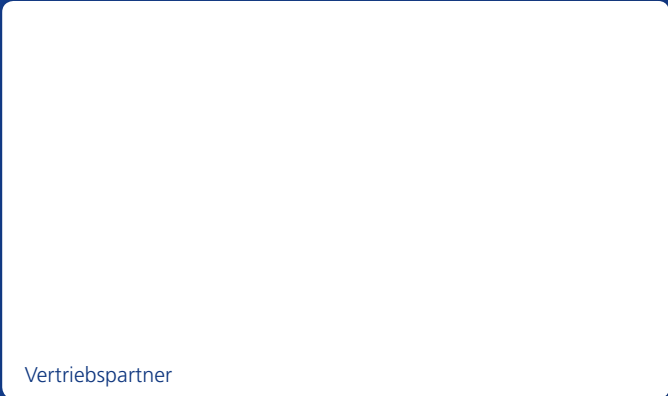

Vertriebspartner

